



# LUCY 25 CHROMED

**NEW**

## MATERIAL:

- Vertical collectors in mild steel  $\varnothing$  30 mm.
- Horizontal heating elements in mild steel  $\varnothing$  25 mm.

## FIXING KIT:

Brackets, airvent, hexagonal tool, plugs and screws for mounting suitable for use on compact or hollow brick, user notice.  
The kit is certified from TÜV in compliance with VDI 6036-class 4.

## PACKAGING:

Carton angular and profiles protected by a recyclable film in polyethylene. User notice included.

## FINISHING:

CHROMED (PLATED IN ITALY)

## ACCESSORIES:

See Accessories chapter

Functioning:	<input checked="" type="checkbox"/> Hot water	<input type="checkbox"/> Dual energy
--------------	---	--------------------------------------

P. Max: 8 bar	Functioning: hot water	T. Max: 110° C	Connections: 2 x 1/2" gas - 1 x 1/2" gas for airvent
---------------	------------------------	----------------	--

## CERTIFICATIONS



## ACCESSORIES



**Kristal valve square with thermostatic option-chromed**

Copper conn.  $\varnothing$  12/14/15  
Art. nr. 5991990311165

Multilayer conn.  $\varnothing$  16  
Art. nr. 5991990311166

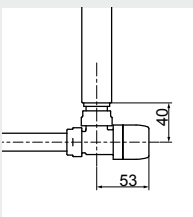

Quotes for square Kristal valves with thermostatic option



**Kristal valve square pipe centres 50 mm with thermostatic option-chromed**

Copper conn.  $\varnothing$  12/14/15  
Art. nr. 5991990301150

Multilayer conn.  $\varnothing$  16  
Art. nr. 5991990301149

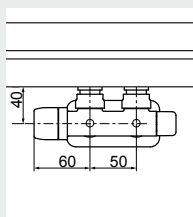

Quotes for square Kristal valves with thermostatic option



**Chromed thermostatic head**

(Kit 2 pieces)  
Art. nr. 5035270710015

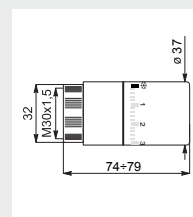

Thermostatic head quotes

If ordered separately from the radiator, the accessories are available in standard white only.

Accessories and spare parts - see Accessories chapter

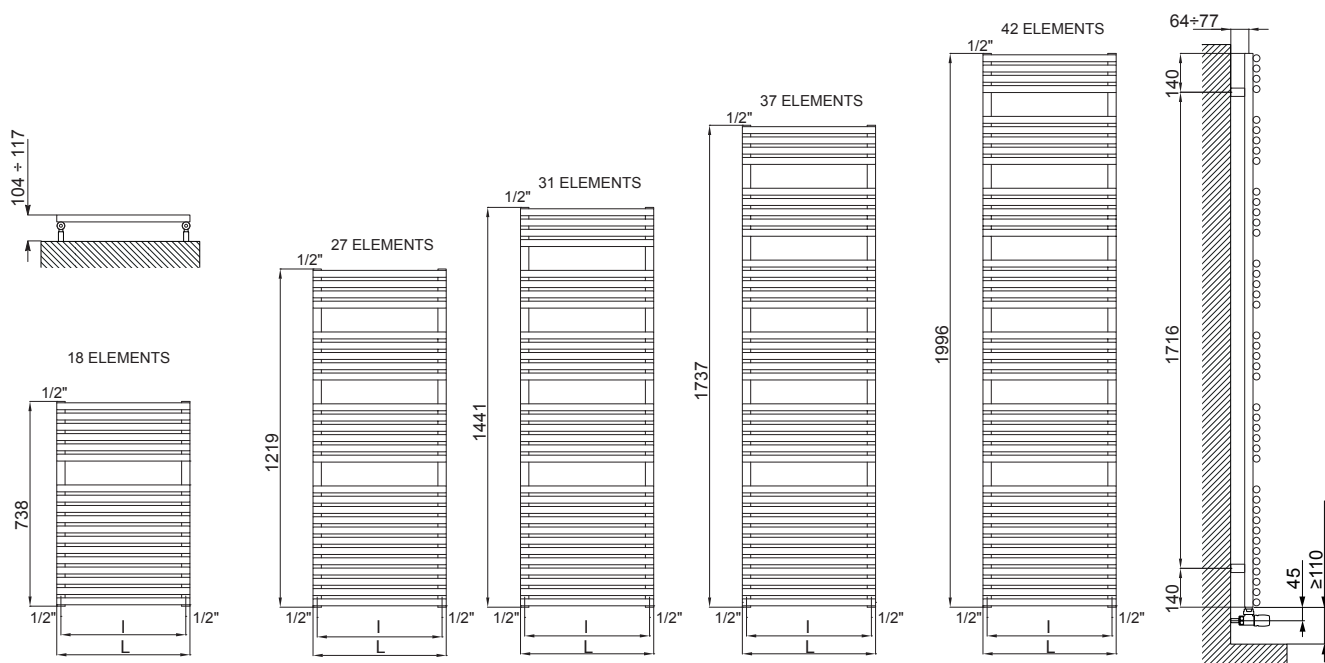

Quotes for Kristal valves

## LUCY 25 CHROMED

Height [mm]	WIDTH L [mm]	Pipe Centres I [mm]	Art. nr.	Dry Weight [Kg]	Surface [m <sup>2</sup> ]	Water content [lt]	Thermal output [Watt]		Exp. n	Dual energy kit [Watt]
							Δt=50°C	Δt=30°C		
<b>738</b>	430	400	3551406110001	5,8	0,747	4,1	290	162	1,1418	300
	480	450	3551406110005	6,4	0,818	4,5	323	180	1,1513	400
<b>1219</b>	430	400	3551406110002	9,0	1,142	6,3	439	243	1,1615	500
	480	450	3551406110006	9,8	1,248	6,8	464	257	1,1565	500
	530	500	3551406110009	10,6	1,354	7,4	507	281	1,1516	600
	580	550	3551406110013	11,4	1,460	8,0	577	322	1,1460	600
<b>1441</b>	430	400	3551406110003	10,4	1,319	7,3	506	282	1,1405	600
	480	450	3551406110007	11,3	1,440	7,9	589	325	1,1676	700
	530	500	3551406110010	12,2	1,562	8,6	615	340	1,1562	700
	580	550	3551406110014	13,1	1,684	9,2	640	354	1,1606	700
<b>1737</b>	430	400	3551406110004	12,4	1,577	8,7	601	333	1,1568	700
	480	450	3551406110008	13,5	1,722	9,5	677	376	1,1529	700
	530	500	3551406110011	14,6	1,868	10,2	706	390	1,1644	700
	580	550	3551406110015	15,7	2,013	11,0	768	423	1,1666	700
<b>1996</b>	530	500	3551406110012	16,6	2,125	11,6	847	468	1,1638	900
	580	550	3551406110016	17,8	2,289	12,5	910	503	1,1610	900
	730	700	3551406110017	21,6	2,784	15,1	1054	581	1,1659	900

For output at different Δt than 50°C, please refer to the following formula:  $\text{desired output} = \text{output at } \Delta t \text{ } 50^{\circ}\text{C} \times (\text{desired } \Delta t / 50)^{1.4}$