



LAURA

POLISHED STAINLESS STEEL



WARRANTY
10 YEARS

MATERIAL:

- Vertical collectors in polished stainless steel \varnothing 30 mm.
- Horizontal elements in polished stainless steel \varnothing 25 mm.

FIXING KIT:

Brackets, airvent, hexagonal tool, plugs and screws for mounting suitable for use on compact or hollow brick, user notice.
The kit is certified from TÜV in compliance with VDI 6036-class 4.

PACKAGING:

Carton angular and profiles protected by a recyclable film in polyethylene. User notice included.

FEATURES:

It is totally made in stainless steel with an unalterable finishing guaranteed during the years.

ACCESSORIES:

See Accessories chapter

Functioning:	<input checked="" type="checkbox"/> Hot water	<input checked="" type="checkbox"/> Electric (see page 358)	
--------------	---	---	--

P. Max: 8 bar	Functioning: hot water	T. Max: 110° C	Connections: 2 x 1/2" gas - 1 x 1/2" gas for airvent
---------------	------------------------	----------------	--

CERTIFICATIONS



ACCESSORIES



Kristal valve square with thermostatic option-chromed

Copper conn. \varnothing 12/14/15
Art. nr. 5991990311165

Multilayer conn. \varnothing 16
Art. nr. 5991990311166

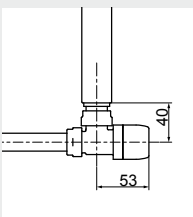

Quotes for square Kristal valves with thermostatic option



Kristal corner valve with thermostatic option-chromed

Copper conn. \varnothing 12/14/15
Art. nr. 5991990301148

Multilayer conn. \varnothing 16
Art. nr. 5991990301147

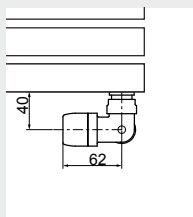

Quotes for corner Kristal valves with thermostatic option



Chromed thermostatic head

(Kit 2 pieces)
Art. nr. 5035270710015

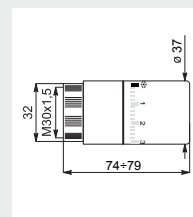

Thermostatic head quotes

Accessories and spare parts - see Accessories chapter

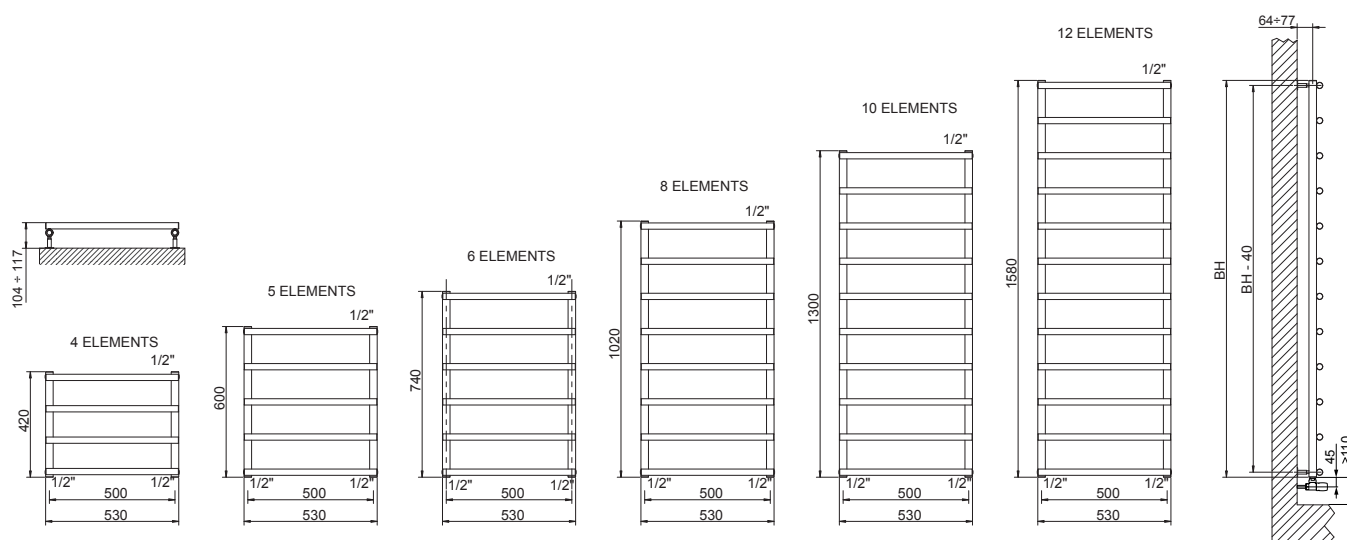

Quotes for Kristal valves

LAURA POLISHED STAINLESS STEEL

Thermal output
[Watt]

Height [mm]	WIDTH L [mm]	Pipe Centres I [mm]	Art. nr.	Dry Weight [Kg]	Surface [m ²]	Water content [lt]	$\Delta t=50^{\circ}\text{C}$	$\Delta t=30^{\circ}\text{C}$	Exp. n
420	530	500	3551570400001	2,57	0,25	1,32	94	51	1,2132
600	530	500	3551570400002	3,36	0,32	1,74	117	63	1,2243
740	530	500	3551570400003	4,03	0,39	2,11	141	74	1,2567
1020	530	500	3551570400004	5,41	0,53	2,86	188	98	1,2672
1300	530	500	3551570400005	6,80	0,66	3,60	235	122	1,2846
1580	530	500	3551570400006	8,18	0,80	4,34	282	145	1,3015

For output at different Δt than 50°C , please refer to the following formula: $\text{desired output} = \text{output at } \Delta t 50^{\circ}\text{C} \times (\text{desired } \Delta t/50)^{1,4}$