



GLORIA 22

CHROMED



EUROPEAN
WARRANTY

MATERIAL:

- Vertical collectors in mild steel \varnothing 30 mm.
- Horizontal heating elements in mild steel \varnothing 22 mm.

FIXING KIT:

Brackets, airvent, hexagonal tool, plugs and screws for mounting suitable for use on compact or hollow brick, user notice.
The kit is certified from TÜV in compliance with VDI 6036-class 4.

PACKAGING:

Carton angular and profiles protected by a recyclable film in polyethylene. User notice included.

FINISHING:

CHROMED (PLATED IN ITALY)

ACCESSORIES:

See Accessories chapter

| | | | |
|--------------|---|--|---|
| Functioning: | <input checked="" type="checkbox"/> Hot water | <input checked="" type="checkbox"/> Electric (see page 340) | <input checked="" type="checkbox"/> Dual energy |
|--------------|---|--|---|

| | | | |
|---------------|------------------------|----------------|--|
| P. Max: 8 bar | Functioning: hot water | T. Max: 110° C | Connections: 2 x 1/2" gas - 1 x 1/2" gas for airvent |
|---------------|------------------------|----------------|--|

CERTIFICATIONS



ACCESSORIES



Kristal valve square with thermostatic option-chromed

Copper conn. \varnothing 12/14/15
Art. nr. 5991990311165

Multilayer conn. \varnothing 16
Art. nr. 5991990311166

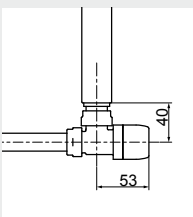

Quotes for square Kristal valves with thermostatic option



Kristal valve corner with thermostatic option-chromed

Copper conn. \varnothing 12/14/15
Art. nr. 5991990301148

Multilayer conn. \varnothing 16
Art. nr. 5991990301147

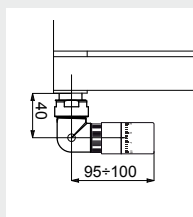

Quotes for corner Kristal valves with thermostatic option



Chromed thermostatic head

(Kit 2 pieces)
Art. nr. 5035270710015

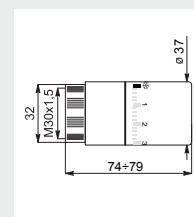

Thermostatic head quotes

If ordered separately from the radiator, the accessories are available in standard white only.

Accessories and spare parts - see Accessories chapter

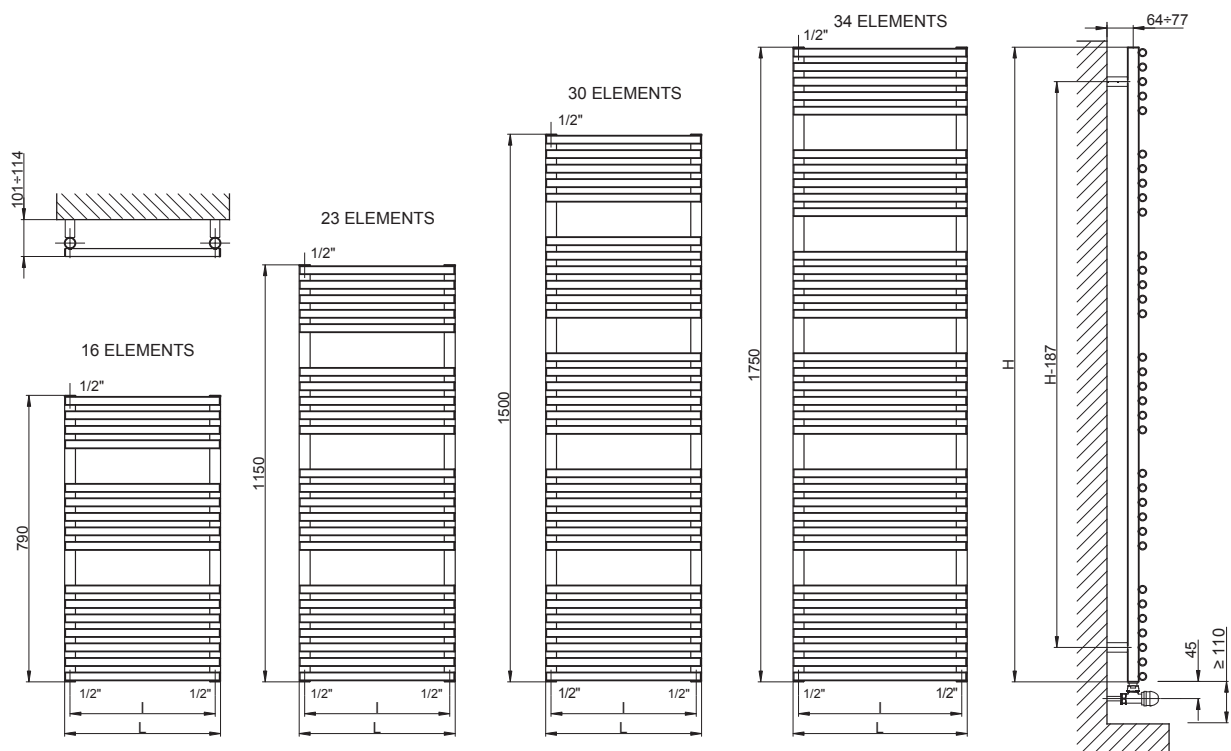

Quotes for Kristal valves

GLORIA 22 CHROMED

| Height [mm] | WIDTH L [mm] | Pipe Centres I [mm] | Art. nr. | Dry Weight [Kg] | Surface [m2] | Water content [lt] | Thermal output [Watt] | | Exp. n | Dual energy kit [Watt] |
|----------------|-----------------|------------------------|---------------|--------------------|-----------------|-----------------------|-------------------------------|-------------------------------|-----------|------------------------------|
| | | | | | | | $\Delta t=50^{\circ}\text{C}$ | $\Delta t=30^{\circ}\text{C}$ | | |
| 790 | 430 | 400 | 3551666101101 | 6,1 | 0,61 | 3,0 | 279 | 151 | 1,1983 | 300 |
| | 480 | 450 | 3551666101102 | 6,6 | 0,66 | 3,1 | 302 | 164 | 1,1941 | 300 |
| 1150 | 430 | 400 | 3551666101103 | 8,8 | 0,88 | 4,2 | 392 | 209 | 1,2348 | 400 |
| | 480 | 450 | 3551666101104 | 9,5 | 0,95 | 4,6 | 426 | 228 | 1,2250 | 500 |
| | 530 | 500 | 3551666101105 | 10,2 | 1,03 | 5,0 | 460 | 247 | 1,2153 | 500 |
| | 580 | 550 | 3551666101106 | 10,9 | 1,10 | 5,3 | 494 | 267 | 1,2055 | 600 |
| | 630 | 600 | 3551666101107 | 11,8 | 1,18 | 5,7 | 528 | 287 | 1,1958 | 600 |
| 1500 | 430 | 400 | 3551666101108 | 11,4 | 1,41 | 5,5 | 502 | 268 | 1,2281 | 600 |
| | 480 | 450 | 3551666101109 | 12,3 | 1,25 | 6,3 | 546 | 292 | 1,2219 | 600 |
| | 530 | 500 | 3551666101110 | 13,2 | 1,32 | 6,5 | 591 | 318 | 1,2157 | 700 |
| | 580 | 550 | 3551666101111 | 14,2 | 1,44 | 6,9 | 636 | 343 | 1,2095 | 700 |
| | 630 | 600 | 3551666101112 | 15,0 | 1,53 | 7,3 | 680 | 368 | 1,2033 | 700 |
| 1750 | 480 | 450 | 3551666101113 | 6,8 | 1,41 | 6,7 | 626 | 336 | 1,2198 | 600 |
| | 530 | 500 | 3551666101114 | 7,3 | 1,50 | 7,4 | 678 | 364 | 1,2160 | 700 |
| | 580 | 550 | 3551666101115 | 7,9 | 1,63 | 7,9 | 730 | 393 | 1,2123 | 900 |
| | 630 | 600 | 3551666101116 | 8,4 | 1,75 | 8,4 | 782 | 422 | 1,2085 | 900 |
| | 730 | 700 | 3551666101117 | 8,9 | 1,86 | 8,9 | 886 | 480 | 1,2009 | 900 |

For output at different Δt than 50°C , please refer to the following formula: $\text{desired output} = \text{output at } \Delta t 50^{\circ}\text{C} \times (\text{desired } \Delta t/50)^{1,4}$