

# BOLLY® 2 XL INOX

316 L STAINLESS STEEL DOMESTIC HOT WATER CALORIFIER  
WITH 2 HIGH PERFORMACE FIXED HEAT EXCHANGERS



## APPLICATION

Production and storage of domestic hot water.

## MATERIAL

Stainless Steel 316 L suitable for domestic hot water according to D.M. n. 174 dated 06.04.04.

## HEAT EXCHANGER

2 stainless steel 316L fixed heat exchangers

## INSULATION

- HARD: High thermal insulation with ecological polyurethane hard foam.  
- SOFT: NOFIRE® polyester fleece 100% made of recyclable material, with high thermal insulation. Fire resistance class B-s2d0 according to EN 13501.

Grey PVC external lining complete with top and flange cover

## CATHODE PROTECTION

Magnesium anode.

## DRAIN

External confluence through drain connection.

## GASKET- FLANGE PLATE

Silicone gaskets suitable for alimentary use; Stainless steel exchanger head.

## WARRANTY

5 years - See general sales conditions and warranty

## ACCESSORIES AND SPARE PARTS

See Accessories section for the entire list.



HARD FOAM INSULATION

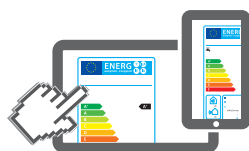

[www.cordivari.com/erp](http://www.cordivari.com/erp)

On line ErP label tool

## BOLLY® 2 XL XB

Model	HARD FOAM insulation Art. Nr.	STAINLESS STEEL HEAT EXCHANGER SURFACE		ENERGY EFFICIENCY CLASS ErP
		Upper	Lower	
200	3135052010202	1,9	1	B
300	3135052010203	2,4	1	B
500	3135052010205	4,5	1,4	C

SOFT FLEECE INSULATION

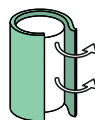

## BOLLY® 2 XL XC

Model	DISMOUNTABLE SOFT FLEECE insulation Art. Nr.	STAINLESS STEEL HEAT EXCHANGER SURFACE		ENERGY EFFICIENCY CLASS ErP
		Upper	Lower	
800	3135052010216	6,2	1,8	C
1000	3135052010217	6	3,8	C

## ELECTRICAL IMMERSION HEATERS

Model	Volume of water heated by the electrical immersion [lt]	Ignition time from 10 °C to 45 °C with immersion heaters [min]		
		1,5 kW	2 kW	3 kW
200	98	176	132	88
300	169	274	206	137
500	305	496	372	248
800	420	752	564	376
1000	534	956	717	478

Accessories on request

## "Easy Control" Electronic Display

ART. NR.	FOR MODELS
5005000310002	XC
5005000310003	XB



## Thermometer

Art. Nr.
5032240000107
5 units box



BOLLY® 2 XL INOX

316 L STAINLESS STEEL DOMESTIC HOT WATER CALORIFIER  
WITH 2 HIGH PERFORMACE FIXED HEAT EXCHANGERS

STORAGE		HEAT EXCHANGER	
Pmax	Tmax	Pmax	Tmax
6 bar	95 °C	12 bar	110 °C

**CORDIVARI®Lab**  
TÜV Rheinland Energie und Umwelt GmbH states that test procedures and Cordivari LAB are certified conforming to European standard EN 15332, as indicated by Ecodesign ErP Directive.

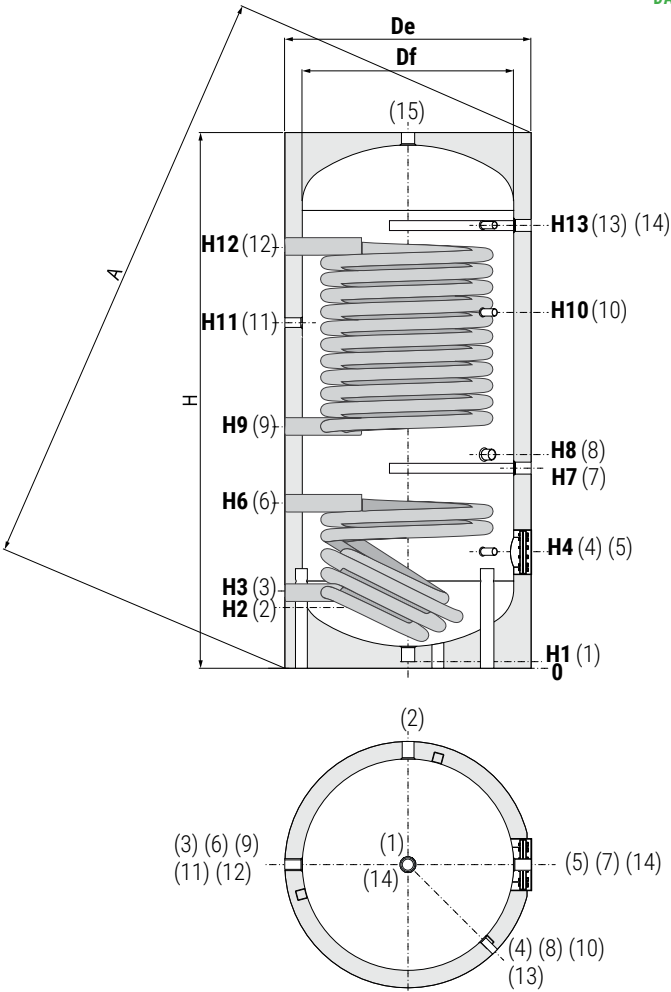
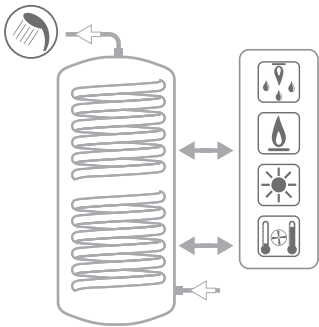

- 1 Drain
- 2 Domestic cold water circuit inlet
- 3 Primary circuit outlet 1" 1/4 Gas F
- 4 Connection for instrumentation 1/2" Gas F
- 5 Blind flange for inspection Ø 120 mm
- 6 Primary circuit inlet 1" 1/4 Gas F
- 7 Connection for magnesium anode 1" 1/4 Gas F
- 8 Connection for electrical immersion 1" 1/2 Gas F  
For models >500 connection 2" Gas F
- 9 Upper heat exchanger outlet 1" 1/4 Gas F
- 10 Connection for instrumentation 1/2" Gas F
- 11 Recirculation 1" Gas F
- 12 Upper heat exchanger inlet 1" 1/4 Gas F
- 13 Connection for instrumentation 1/2" Gas F
- 14 Connection for 2<sup>nd</sup> anode 1"1/4 Gas F (only for models > 500)
- 15 Domestic hot water outlet

HARD FOAM INSULATION (XB)

Model	Volume [lt]	De	H	A	H1	H2	H3	H4	H6	H7	H8	H9	H10	H11	H12	H13	1	2	15
																	Connections Gas F		
200	191	550	1446	1547	71	206	296	326	533	646	726	801	886	1046	1206	960	1/2"	1"	1"
300	293	650	1501	1636	76	236	326	386	572	626	706	741	1096	989	1236	1236	1/2"	1"	1"
500	503	750	1796	1946	71	256	356	411	601	686	766	810	1299	1148	1485	1496	1/2"	1"	1"

SOFT FLEECE INSULATION (XC)

Model	Volume [lt]	Df	De	H	A	H1	H2	H3	H4	H6	H7	H8	H9	H10	H11	H12	H13	1	2	15
																		Connections Gas F		
800	759	790	1010	1943	1986	114	323	423	478	664	696	756	800	1383	1213	1548	1568	3/4"	1"	1"1/4
1000	902	800	1020	2192	2231	112	317	412	477	873	908	963	1008	1564	1452	1756	1792	3/4"	1"1/4	1"1/4

P.E.D. product designed and produced in conformity to the article 4.3 of directive 2014/68/UE - ErP Ecodesign directive 2009/125/CE

EXTRA-BOLLY®  
CALORIFIERS

BOLLYTERM®  
CALORIFIERS

STAINLESS STEEL  
CALORIFIERS

CALORIFIERS FOR  
HEAT PUMP

MULTIFUEL ENERGY  
CYLINDERS - PUFFER

HYDRONIC

INERTIAL  
TANKS

WATER PRESSURE  
TANKS

COMPRESSED AIR  
RECEIVERS

ACCESSORIES  
AND SPARE PARTS

TECHNICAL  
SUPPORT