

# VASO A MEMBRANA VERNICIATO PED VT

VERTICAL PAINTED EXPANSION VESSEL WITH MEMBRANE (DIRECTIVE 2014/68/UE)



Model VASO MEMB. V PED VT

	Art. Nr.
<b>50</b>	3911162241007
<b>80</b>	3911162241008
<b>100</b>	3911162241003
<b>200</b>	3911162241004
<b>300</b>	3911162241005
<b>500</b>	3911162241006



## TECHNICAL DESCRIPTION

Vertical V PED expansion vessels with membrane are used for lifted water system and they represent a pressurised water lung that, if duly dimensioned, reduces pump cycling.

The peculiarity of this product is the physic separation between water and air made by the membrane.

## APPLICATION

Perfect to ensure water deliveries to the top floors of the building or to work in case of insufficient water supplied by waterworks, or to stabilize pressure in the domestic water supply by absorbing expansion when the water is heated.

## MATERIAL

Painted mild steel.

## MEMBRANE

Elastic EPDM membrane suitable for drinking water.

## CERTIFICATIONS

V PED VT expansion vessels with membrane are produced in accordance with safety disposal of European Directive 2014/68/UE in terms of pressurized.

They are CE labelled with design data:

- pressurized fluid: water+air or nitrogen
- Fluid group: 2
- max. working pressure: 10bar

## DOCUMENTS ATTACHED

- CE certification
- User Instructions

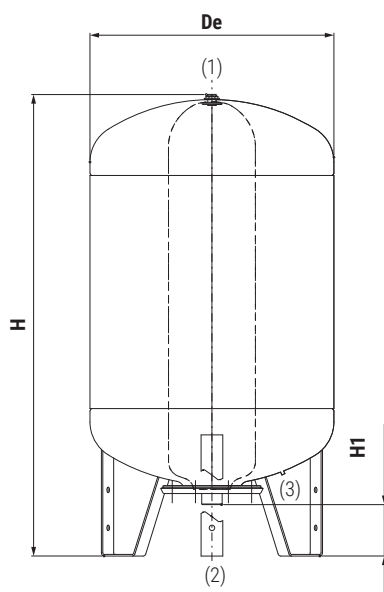

Model	De	H	H1	1	2	3	Working condition	
							Temp. min/max	Press. max
	[mm]				Connections Gas		[°C]	[bar]
<b>50</b>	400	627	91	Air inlet valve	1" M	-	-10/+99	10
<b>80</b>	450	717	88		1" M	-	-10/+99	10
<b>100</b>	450	872	88	1/2" Instrumentation	1" M	Water in/out	-10/+99	10
<b>200</b>	550	1187	151	1/2" Instrumentation	1" 1/4 F	Air inlet valve	-10/+99	10

Model	De	H	H1	1	2	3	Used as air cushion pressure vessels		Used as expansion vessel	
							Temp. min/max	Press. max	Temp. min/max	Press. max
	[mm]				Connections Gas		[°C]	[bar]	[°C]	[bar]
<b>300</b>	650	1254	150	1/2" Instrumentation	1" 1/4 F	Water in/out	-10/+50	10	-10/+99	6
<b>500</b>	750	1511	144	1/2" Instrumentation	1" 1/4 F	Air inlet valve	-10/+50	10	-10/+99	6

# VASO A MEMBRANA VERNICIATO PED 24 LT

PAINTED EXPANSION VESSEL WITH MEMBRANE (DIRECTIVE 2014/68/UE)



PRESSURE	TEMPERATURE
Pmax	Tmax
8 bar	-10/+99 °C



Model	VASO MEMB. V PED 24 LT
	Art. Nr.
<b>24</b>	3901190610001

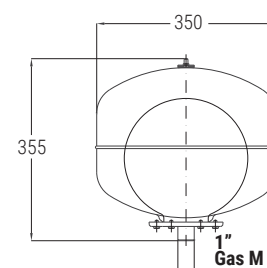

# VASO A MEMBRANA VERNICIATO PED OR

HORIZONTAL PAINTED EXPANSION VESSEL WITH MEMBRANE (DIRECTIVE 2014/68/UE)

Model VASO MEMB. V PED OR

	Art. Nr.
<b>50</b>	3911161341007
<b>80</b>	3911161341008
<b>100</b>	3911161341003
<b>200</b>	3911161341004
<b>300</b>	3911161341005



## TECHNICAL DESCRIPTION

Horizontal V PED expansion vessels with membrane are used for lifted water system and they represent a pressurized water lung that, if duly dimensioned, reduces pump cycling.

The peculiarity of this product is the physic separation between water and air made by the membrane.

## APPLICATION

Perfect to ensure water deliveries to the top floors of the building or to work in case of insufficient water supplied by waterworks, or to stabilize pressure in the domestic water supply by absorbing expansion when the water is heated.

## MATERIAL

Painted mild steel.

## MEMBRANE

Elastic EPDM membrane suitable for drinking water.

## CERTIFICATIONS

V PED OR expansion vessels with membrane are produced in accordance with safety disposal of European Directive 2014/68/UE in terms of pressurized.

They are CE labelled with design data:

- pressurized fluid: water+air or nitrogen
- Fluid group: 2
- max. working pressure: 10bar

## DOCUMENTS ATTACHED

- CE certification
- User Instructions

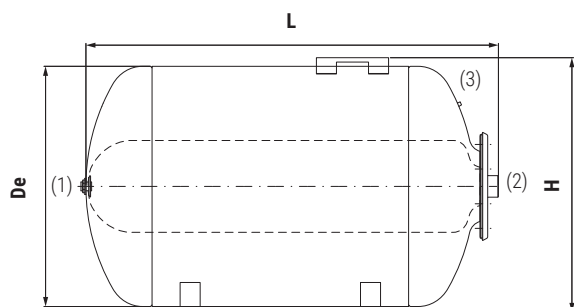

Model	De	H	H1	1	2	3	Working condition	
							Temp. min/max	Press. max
					Connections Gas		[°C]	[bar]
<b>50</b>	400	424	583	Air inlet valve	1" M	Water in/out	-	-10/+99
<b>80</b>	450	473	598		1" M		-	-10/+99
<b>100</b>	450	473	783	1/2" Instrumentation	1" M	Air inlet valve	-	-10/+99
<b>200</b>	550	583	1066	1/2" Instrumentation	1" 1/4 F		-	-10/+99

Model	De	H	H1	1	2	3	Used as air cushion pressure vessels		Used as expansion vessel	
							Temp. min/max	Press. max	Temp. min/max	Press. max
					Connections Gas		[°C]	[bar]	[°C]	[bar]
<b>300</b>	650	807	1080	1/2" Instrumentation	1" 1/4 F Water in/out	Air inlet valve	-10/+50	10	-10/+99	6

## MOTOR SUPPORT PLATE

MOTOR SUPPORT PLATE  
50/80/100/200 liters

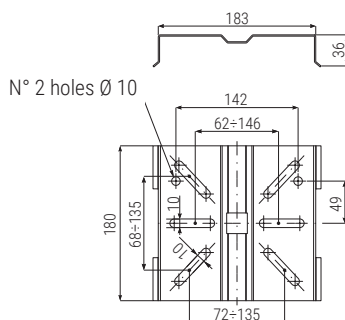

MOTOR SUPPORT PLATE  
300/500 liters

