

# RAPID HEAT EXCHANGER



## TECHNICAL DESCRIPTION

Rapid heat exchangers are made by a double spiral copper coil covered with mild steel tubes. Its particular internal configuration forces the two fluids to go upstream and guarantees a rapid and efficient thermal exchange. They can be used in several ways in thermo-hydraulic domain, such as for DHW production combined with thermo-fireplaces or biomass generators.

## APPLICATION

Immediate DHW production .

## MATERIAL

Mild steel

## HEAT EXCHANGER

Fixed double spiral copper coil heat exchanger.

## WARRANTY

2 years

See general sales conditions and warranty.

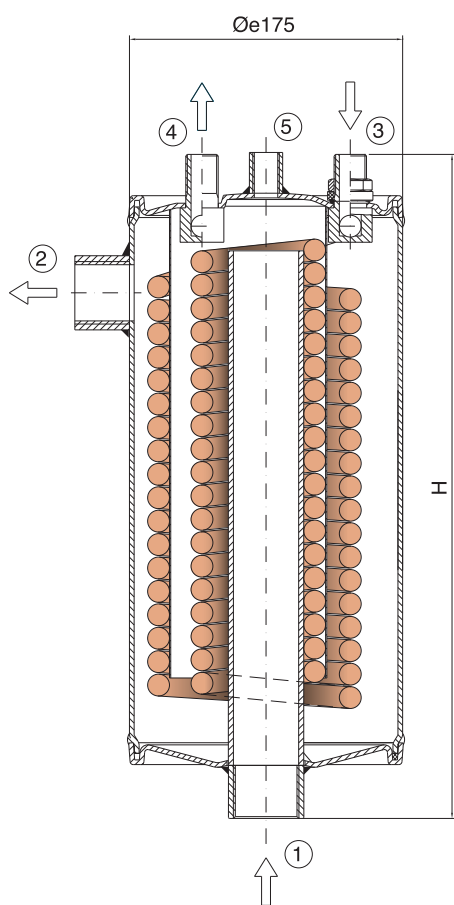

- 1 Primary Inlet
- 2 Primary Outlet
- 3 Secondary Inlet
- 4 Secondary Outlet
- 5 Air purge

## RAPID HEAT EXCHANGER

Model	Art. Nr.	HEAT EXCHANGER SURFACE
		[m <sup>2</sup> ]
<b>24000</b>	3681160120001	0,5
<b>35000</b>	3681160120002	0,7
<b>45000</b>	3681160120003	0,9

Model	External exchange diameter	Height H	1-2	3-4	5
	[mm]		Connections		
<b>24000</b>	175	320	1" 1/2	1/2"	3/8"
<b>35000</b>		425	1" 1/2	1/2"	3/8"
<b>45000</b>		525	1" 1/2	1/2"	3/8"

### Primary circuit temperature 85 °C, secondary from 10 to 60 °C

Model	Exchanged power		Flow rate	D.H.W. production
	[Kcal/h]	[Kw]		
<b>24000</b>	24200	28,14	1880	480
<b>35000</b>	35651	41,46	2150	709
<b>45000</b>	45124	52,48	2380	897

### Primary circuit temperature 75 °C, secondary from 10 to 45 °C

	Exchanged power		Flow rate	D.H.W. production
	[Kcal/h]	[Kw]		
	24147	28,08	1880	685
	35335	41,09	2150	1004
	44554	51,82	2380	1267