

# PLATE HEAT EXCHANGERS



## WORKING CONDITION

Max pressure	Max temperature
10/16 bar	140 °C (*)

(\*) Is intended as maximum working temperature of Gaskets. The maximum operating temperature must be lower between those corresponding to the vapor pressure of 0.5 bar above the pressure in normal atmospheres considered for two circulating fluids. For a use of temperatures above 110 °C please see the TECHNICAL SUPPORT section

## APPLICATION

PHC Heat exchangers are used in domestic and industrial installation. In particular they're suitable for production of D.H.W., as well as for heating of swimming pools using different energy sources (traditional boiler, solid fuel, solar thermal system). For domestic application, the PHC are suitable for district heating installation.

## MATERIAL

- Frame (not in contact with fluids) in painted mild steel
- Guide for Heat exchanger plates, bolts and screw nuts (not in contact with fluids) in galvanized mild steel
- Nipples and plates (in contact with fluid) in 316L Stainless Steel
- EPDM Gaskets.

## TECHNICAL DESCRIPTION

PHC exchangers are inspectionable plate to plate type. Their shape ensures the possibility of opening the exchanger for cleaning.

The modular design allows you to change the configuration of the exchanger even after a period of use (within certain limits).

PHC exchangers are designed for the use stated on Art. 3.3 of PED 97/23/CE. In particular, they are intended to be used with non-dangerous liquids with steam pressure at maximum operating temperature not exceeding 0.5 bar above normal atmospheric pressure. Every Exchanger has serial number label and end-user manual.

## CHEMICAL COMPATIBILITY

Material used for PHC Exchangers are suitable for following liquids:

- Water • WATER POOL • Milk • Whisky • Acetone • Glycole • Glycoled Water • Mineral Water • Wine • Wine Vinegar • Etanol • Etilenic Glycole • De-mineralized Water • Acetic Acid • Beer • Liquors • Methanol • Propylenic Glycol

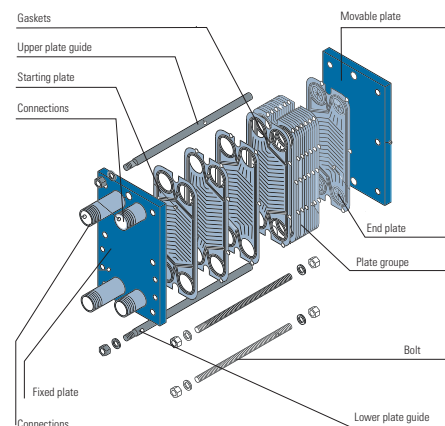

## EXCHANGERS PHC 3120 - DN32

(PN16 VERSION ON REQUEST)



	N° of plates	With EPDM gaskets		With NBR gaskets		S Fixing quote	L	Primary Vol. = Secondary Vol.	
		PN10 VERSION	PN16 VERSION	PN10 VERSION	PN16 VERSION				
		Art. Nr.		Art. Nr.		[mm]	[mm]	[lt]	
		3175056654151		3175056654121		27		0,20	
		3175056654152		3175056654122		33		0,25	
		3175056654153		3175056654123		39		0,30	
		3175056654154		3175056654124		45		0,35	
		3175056654155		3175056654125		51		0,40	
		3175056654156		3175056654126		57		0,45	
		3175056654157		3175056654127		63	220	0,50	
		3175056654158		3175056654128		69		0,55	
		3175056654159		3175056654129		75		0,60	
		3175056654160		3175056654130		81		0,65	
		3175056654161		3175056654131		87		0,70	
		3175056654162		3175056654132		93		0,75	
		3175056654163		3175056654133		99		0,80	
		3175056654164		3175056654134		105		0,85	
		3175056654165		3175056654135		111		0,90	
		3175056654166		3175056654136		117		0,95	
		3175056654167		3175056654137		123		1,00	
		3175056654168		3175056654138		129		1,05	
		3175056654169		3175056654139		135		1,10	
		3175056654170		3175056654140		141		1,15	
		3175056654171		3175056654141		147	370	1,20	
		3175056654172		3175056654142		153		1,25	
		3175056654173		3175056654143		159		1,30	
		3175056654174		3175056654144		165		1,35	
		3175056654175		3175056654145		171		1,40	
		3175056654176		3175056654146		177		1,45	
		3175056654177		3175056654147		183		1,50	
		3175056654178		3175056654148		189		1,55	
		3175056654179		3175056654149		195		1,60	
		3175056654180		3175056654150		201		1,65	

EXCHANGERS PHC 4620 - DN32

(PN16 VERSION ON REQUEST)



STOCK  
AVAILABILITY

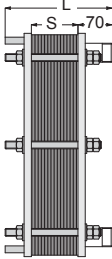
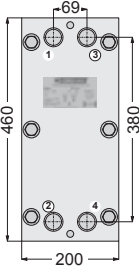

Connections

DN32 (1"1/4)

Gas M

1	Primary Inlet
2	Primary Outlet
3	Secondary Outlet
4	Secondary Inlet

N° of plates	With EPDM gaskets PN10 VERSION	PN16 VERSION	With NBR gaskets PN10 VERSION	PN16 VERSION	S Fixing quote	L	Primary Vol. = Secondary Vol.
	Art. Nr.		Art. Nr.		[mm]	[mm]	[lt]
9	3175056654271	WITH SURCHARGE	3175056654241	WITH SURCHARGE	27	220	0,36
11	3175056654272		3175056654242		33		0,45
13	3175056654273		3175056654243		39		0,54
15	3175056654274		3175056654244		45		0,63
17	3175056654275		3175056654245		51		0,72
19	3175056654276		3175056654246		57		0,81
21	3175056654277		3175056654247		63		0,90
23	3175056654278		3175056654248		69		0,99
25	3175056654279		3175056654249		75		1,08
27	3175056654280		3175056654250		81		1,17
29	3175056654281	WITH SURCHARGE	3175056654251	WITH SURCHARGE	87	370	1,26
31	3175056654282		3175056654252		93		1,35
33	3175056654283		3175056654253		99		1,44
35	3175056654284		3175056654254		105		1,53
37	3175056654285		3175056654255		111		1,62
39	3175056654286		3175056654256		117		1,71
41	3175056654287		3175056654257		123		1,80
43	3175056654288		3175056654258		129		1,89
45	3175056654289		3175056654259		135		1,98
47	3175056654290		3175056654260		141		2,07
49	3175056654291	WITH SURCHARGE	3175056654261	WITH SURCHARGE	147		2,16
51	3175056654292		3175056654262		153		2,25
53	3175056654293		3175056654263		159		2,34
55	3175056654294		3175056654264		165		2,43
57	3175056654295		3175056654265		171		2,52
59	3175056654296		3175056654266		177		2,61
61	3175056654297		3175056654267		183		2,70
63	3175056654298		3175056654268		189		2,79
65	3175056654299		3175056654269		195		2,88
67	3175056654300		3175056654270		201		2,97

EXCHANGERS PHC 7420 - DN32

(PN16 VERSION ON REQUEST)



STOCK  
AVAILABILITY

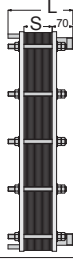
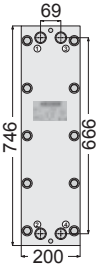

Connections

DN32 (1"1/4)

1	Primary Inlet
2	Primary Outlet
3	Secondary Outlet
4	Secondary Inlet

N° of plates	With EPDM gaskets PN10 VERSION	PN16 VERSION	With NBR gaskets PN10 VERSION	PN16 VERSION	S Fixing quote	L	Primary Vol. = Secondary Vol.
	Art. Nr.		Art. Nr.		[mm]	[mm]	[lt]
9	3175056654391	WITH SURCHARGE	3175056654361	WITH SURCHARGE	27	220	0,68
11	3175056654392		3175056654362		33		0,85
13	3175056654393		3175056654363		39		1,02
15	3175056654394		3175056654364		45		1,19
17	3175056654395		3175056654365		51		1,36
19	3175056654396		3175056654366		57		1,53
21	3175056654397		3175056654367		63		1,70
23	3175056654398		3175056654368		69		1,87
25	3175056654399		3175056654369		75		2,04
27	3175056654400		3175056654370		81		2,21
29	3175056654401	WITH SURCHARGE	3175056654371	WITH SURCHARGE	87	370	2,38
31	3175056654402		3175056654372		93		2,55
33	3175056654403		3175056654373		99		2,72
35	3175056654404		3175056654374		105		2,89
37	3175056654405		3175056654375		111		3,06
39	3175056654406		3175056654376		117		3,23
41	3175056654407		3175056654377		123		3,40
43	3175056654408		3175056654378		129		3,57
45	3175056654409		3175056654379		135		3,74
47	3175056654410		3175056654380		141		3,91
49	3175056654411	WITH SURCHARGE	3175056654381	WITH SURCHARGE	147		4,08
51	3175056654412		3175056654382		153		4,25
53	3175056654413		3175056654383		159		4,42
55	3175056654414		3175056654384		165		4,59
57	3175056654415		3175056654385		171		4,76
59	3175056654416		3175056654386		177		4,93
61	3175056654417		3175056654387		183		5,10
63	3175056654418		3175056654388		189		5,27
65	3175056654419		3175056654389		195		5,44
67	3175056654420		3175056654390		201		5,61

EXTRA-BOLLY®  
CALORIFIERS

BOLLYTERM®  
CALORIFIERS

STAINLESS STEEL  
CALORIFIERS

CALORIFIERS FOR  
HEAT PUMP

MULTIFUEL ENERGY  
CYLINDERS - PUFFER

HYDRONIC

INERTIAL  
TANKS

WATER PRESSURE  
TANKS

COMPRESSED AIR  
RECEIVERS

ACCESSORIES  
AND SPARE PARTS

TECHNICAL  
SUPPORT

# EXCHANGERS PHC 7431 - DN65



per versione pn16 Art. Nr. a richiesta)

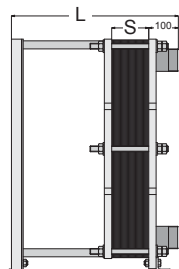
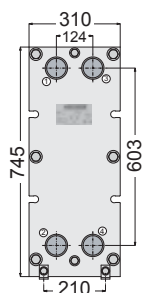

Connections

**DN65 2"1/2**

1	Primary Inlet
2	Primary Outlet
3	Secondary Outlet
4	Secondary Inlet

N° of  
plates

## With EPDM gaskets PN10 VERSION

PN16  
VERSION

## With NBR gaskets PN10 VERSION

PN16  
VERSION

S Fixing  
quote

L

Primary Vol. =  
Secondary Vol.

Art. Nr.	Art. Nr.	[mm]	[mm]	[lt.]
13	3175056654533	44	405	2,16
15	3175056654534	51		2,52
17	3175056654535	58		2,88
19	3175056654536	65		3,24
21	3175056654537	71		3,60
23	3175056654538	78		3,96
25	3175056654539	85		4,32
27	3175056654540	92		4,68
29	3175056654541	99	505	5,04
31	3175056654542	105		5,40
33	3175056654543	112		5,76
35	3175056654544	119		6,12
37	3175056654545	126		6,48
39	3175056654546	133		6,84
41	3175056654547	139		7,20
43	3175056654548	146		7,56
45	3175056654549	153		7,92
47	3175056654550	160	605	8,28
49	3175056654551	167		8,64
51	3175056654552	173		9,00
53	3175056654553	180		9,36
55	3175056654554	187		9,72
57	3175056654555	194		10,08
59	3175056654556	201		10,44
61	3175056654557	207		10,80
63	3175056654558	214	855	11,16
65	3175056654559	221		11,52
67	3175056654560	228		11,88
69	3175056654561	235		12,24
71	3175056654562	241		12,60
73	3175056654563	248		12,96
75	3175056654564	255		13,32
77	3175056654565	262		13,68
79	3175056654566	269		14,04
81	3175056654567	275	855	14,40
83	3175056654568	282		14,76
85	3175056654569	289		15,12
87	3175056654570	296		15,48
89	3175056654571	303		15,84
91	3175056654572	309		16,20
93	3175056654573	316		16,56
95	3175056654574	323		16,92
97	3175056654575	330	855	17,28
99	3175056654576	337		17,64
101	3175056654577	343		18,00
103	3175056654578	350		18,36
105	3175056654579	357		18,72
107	3175056654580	364		19,08
109	3175056654581	371		19,44
111	3175056654582	377		19,80
113	3175056654583	384	855	20,16
115	3175056654584	391		20,52

EXCHANGERS PHC 8031 - DN50

(PN16 VERSION ON REQUEST)



STOCK  
AVAILABILITY

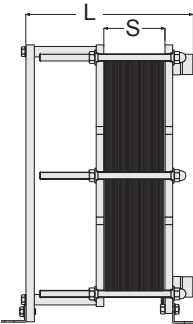
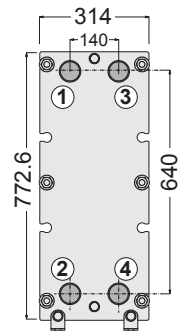

Connections	
DN50 (2")	
1	Primary Inlet
2	Primary Outlet
3	Secondary Outlet
4	Secondary Inlet

N° of plates	With EPDM gaskets PN10 VERSION		PN16 VERSION	With NBR gaskets PN10 VERSION		PN16 VERSION	S Fixing quote	L	Primary Vol. = Secondary Vol.
	Art. Nr.			Art. Nr.					
13	3175056654741		WITH SURCHARGE	3175056654689		WITH SURCHARGE	46	405	2,28
15	3175056654742			3175056654690			53		2,66
17	3175056654743			3175056654691			60		3,04
19	3175056654744			3175056654692			67		3,42
21	3175056654745			3175056654693			74		3,80
23	3175056654746			3175056654694			81		4,18
25	3175056654747			3175056654695			88		4,56
27	3175056654748			3175056654696			95		4,94
29	3175056654749			3175056654697			102	505	5,32
31	3175056654750			3175056654698			109		5,70
33	3175056654751			3175056654699			116		6,08
35	3175056654752			3175056654700			123		6,46
37	3175056654753			3175056654701			130		6,84
39	3175056654754			3175056654702			137		7,22
41	3175056654755			3175056654703			144		7,60
43	3175056654756			3175056654704			151		7,98
45	3175056654757			3175056654705			158		8,36
47	3175056654758			3175056654706			165	605	8,74
49	3175056654759			3175056654707			172		9,12
51	3175056654760			3175056654708			179		9,50
53	3175056654761			3175056654709			186		9,88
55	3175056654762			3175056654710			193		10,26
57	3175056654763			3175056654711			200		10,64
59	3175056654764			3175056654712			207		11,02
61	3175056654765			3175056654713			214		11,40
63	3175056654766			3175056654714			221		11,78
65	3175056654767			3175056654715			228		12,16
67	3175056654768		WITH SURCHARGE	3175056654716		WITH SURCHARGE	235	855	12,54
69	3175056654769			3175056654717			242		12,92
71	3175056654770			3175056654718			249		13,30
73	3175056654771			3175056654719			256		13,68
75	3175056654772			3175056654720			263		14,06
77	3175056654773			3175056654721			270		14,44
79	3175056654774			3175056654722			277		14,82
81	3175056654775			3175056654723			284		15,20
83	3175056654776			3175056654724			291		15,58
85	3175056654777			3175056654725			298		15,96
87	3175056654778			3175056654726			305		16,34
89	3175056654779			3175056654727			312		16,72
91	3175056654780			3175056654728			319		17,10
93	3175056654781			3175056654729			326		17,48
95	3175056654782			3175056654730			333		17,86
97	3175056654783			3175056654731			340		18,24
99	3175056654784			3175056654732			347		18,62
101	3175056654785			3175056654733			354		19,00
103	3175056654786			3175056654734			361		19,38
105	3175056654787			3175056654735			368		19,76
107	3175056654788			3175056654736			375		20,14
109	3175056654789			3175056654737			382		20,52
111	3175056654790			3175056654738			389		20,90
113	3175056654791			3175056654739			396		21,28
115	3175056654792			3175056654740			403		21,66

- EXTRA-BOLLY®  
CALORIFIERS
- BOLLYTERM®  
CALORIFIERS
- STAINLESS STEEL  
CALORIFIERS
- CALORIFIERS FOR  
HEAT PUMP
- MULTIFUEL ENERGY  
CYLINDERS - PUFFER
- HYDRONIC
- INERTIAL  
TANKS
- WATER PRESSURE  
TANKS
- COMPRESSED AIR  
RECEIVERS
- ACCESSORIES  
AND SPARE PARTS
- TECHNICAL  
SUPPORT

# EXCHANGERS PHC 12046 - DN100

(PN16 VERSION ON REQUEST)

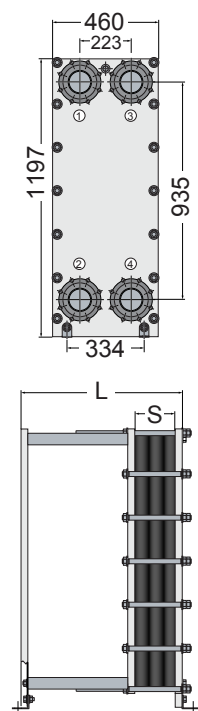

CONNECTIONS	
<b>DN100 PN16</b>	
<b>FLANGED</b>	
1	Primary Inlet
2	Primary Outlet
3	Secondary Outlet
4	Secondary Inlet

N° of plates

## With EPDM gaskets PN10 VERSION

PN16  
VERSION

## With NBR gaskets PN10 VERSION

PN16  
VERSION

S Fixing  
quote

L

Primary Vol. =  
Secondary Vol.

Art. Nr.	Art. Nr.	[mm]	[mm]	[lt]
13	3175056654949	40	550	5,07
15	3175056654950	47		5,92
17	3175056654951	53		6,76
19	3175056654952	59		7,61
21	3175056654953	65		8,45
23	3175056654954	71		9,30
25	3175056654955	78		10,14
27	3175056654956	84		10,99
29	3175056654957	90		11,83
31	3175056654958	96		12,68
33	3175056654959	102		13,52
35	3175056654960	109		14,37
37	3175056654961	115		15,21
39	3175056654962	121		16,06
41	3175056654963	127		16,90
43	3175056654964	133	710	17,75
45	3175056654965	140		18,59
47	3175056654966	146		19,44
49	3175056654967	152		20,28
51	3175056654968	158		21,13
53	3175056654969	164		21,97
55	3175056654970	171		22,82
57	3175056654971	177		23,66
59	3175056654972	183		24,51
61	3175056654973	189		25,35
63	3175056654974	195		26,20
65	3175056654975	202		27,04
67	3175056654976	208		27,89
69	3175056654977	214		28,73
71	3175056654978	220	710	29,58
73	3175056654979	226		30,42
75	3175056654980	233		31,27
77	3175056654981	239		32,11
79	3175056654982	245		32,96
81	3175056654983	251		33,80
83	3175056654984	257		34,65
85	3175056654985	264		35,49
87	3175056654986	270		36,34
89	3175056654987	276		37,18
91	3175056654988	282		38,03
93	3175056654989	288		38,87
95	3175056654990	295		39,72
97	3175056654991	301		40,56
99	3175056654992	307		41,41
101	3175056654993	313		42,25
103	3175056654994	319		43,10
105	3175056654995	326		43,94
107	3175056654996	332		44,79
109	3175056654997	338		45,63
111	3175056654998	344		46,48
113	3175056654999	350		47,32
115	3175056655000	357		48,17

WITH  
SURCHARGE

WITH  
SURCHARGE

WITH  
SURCHARGE

WITH  
SURCHARGE