

EXTRA 2 INOX

316 L STAINLESS STEEL CALORIFIERS WITH 2 EXTRACTABLE HEAT EXCHANGERS



APPLICATION

Production and storage of domestic hot water.

MATERIAL

Stainless Steel 316 L suitable for domestic hot water according to D.M. n. 174 dated 06.04.04.

HEAT EXCHANGER

2 Stainless steel 316L Antilegionella® heat exchangers (upper exchanger is straight and the other is bent to the bottom).

INSULATION

- HARD: High thermal insulation with ecological polyurethane hard foam.
- SOFT: NOFIRE® polyester fleece 100% made of recyclable material, with high thermal insulation. Fire resistance class B-s2d0 according to EN 13501.

Grey PVC external lining complete with top and flange cover

CATHODE PROTECTION

Magnesium anode. - Models > 1500 n° 2 magnesium anodes.

DRAIN

External confluence through drain connection.

GASKET- FLANGE PLATE

Silicone gaskets suitable for alimentary use; Mild steel exchanger head with anticorrosion treatment.

WARRANTY

5 years - See general sales conditions and warranty

ACCESSORIES AND SPARE PARTS

See Accessories section for the entire list.



HARD FOAM INSULATION

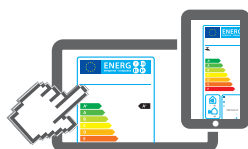

www.cordivari.com/erp

On line ErP label tool

SOFT FLEECE INSULATION



EXTRA 2 XXB

Model	HARD FOAM insulation Art. Nr.	STAINLESS STEEL HEAT EXCHANGER SURFACE		ENERGY EFFICIENCY CLASS
		Lower	Upper	
		[m²]		
200	3082052300222	0,5	0,5	C
300	3082052300223	0,75	0,75	C
500	3082052300224	1,5	1,5	C

EXTRA 2 XXC

Model	DISMOUNTABLE SOFT FLEECE insulation Art. Nr.	STAINLESS STEEL HEAT EXCHANGER SURFACE		ENERGY EFFICIENCY CLASS
		Lower	Upper	
		[m²]		
800	3082052300230	2	2	C
1000	3082052300231	3	2	C
1300	3082052300232	3	3	C
1500	3082052300233	3	3	C
2000	3082052300234	4	4	C
2500	3082052300210	5	5	
3000	3082052300212	6	6	
4000	3082052300214	8	8	
5000	3082052300216	10	10	

ELECTRICAL IMMERSION HEATERS

Mod.	Volume of water heated by the electrical immersion [lt]	MONOPHASE			THREEPHASE				
		1,5 kW	2 kW	3 kW	4 kW	5 kW	6 kW	9 kW	12 kW
		52400000000051	52400000000052	52400000000053	52400000000047	52400000000048	52400000000049	52400000000050	52400000000031
Ignition time from 10 °C to 45 °C with immersion heaters [min]									
200	49	87	65	44	//	//	//	//	//
300	76	136	102	68	//	//	//	//	//
500	127	228	171	114	//	//	//	//	//
800	178	318	239	159	//	//	//	//	//
1000	243	436	327	218	163	131	109	73	54
1500	288	516	387	258	194	155	129	86	65
2000	443	793	595	396	297	238	198	132	99
2500	577	1033	775	517	387	310	258	172	129
3000	577	1033	775	517	387	310	258	172	129
4000	797	1428	1071	714	535	428	357	238	178
5000	1040	1864	1398	932	699	559	466	311	233

— Accessories on request —

"Easy Control" Electronic Display

ART. NR.	FOR MODELS
5005000310002	XXC
5005000310003	XXB



EXTRA 2 INOX

316 L STAINLESS STEEL CALORIFIERS WITH 2 EXTRACTABLE HEAT EXCHANGERS

STORAGE		HEAT EXCHANGER	
Pmax	Tmax	Pmax	Tmax
6 bar	95 °C	12 bar	110 °C



CORDIVARI Lab
TÜV Rheinland Energie und Umwelt GmbH states that test procedures and Cordivari LAB are certified conforming to European standard EN 15332, as indicated by Ecodesign ErP Directive.



ASK ALWAYS FOR CERTIFIED LABORATORIES DATA RESULTS

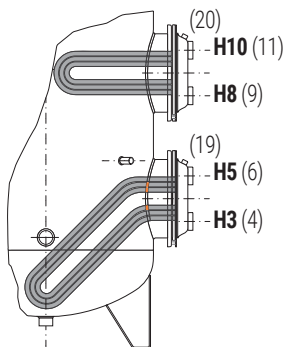
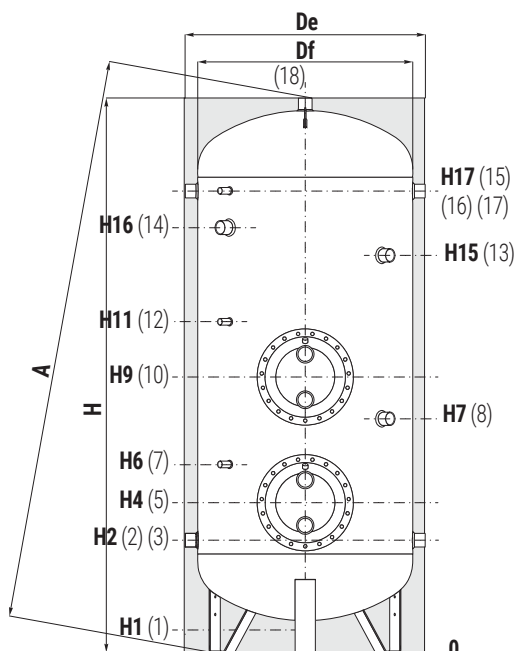

Models with 3 extractable heat exchangers available upon request

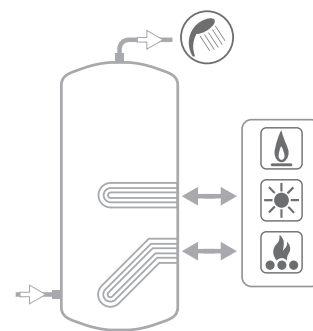
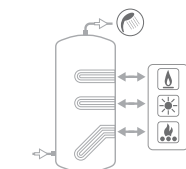

1	Drain 3/4" Gas F for models da 200 a 1000; 1" Gas F for models > 1000
2	Domestic cold water circuit inlet
3	Alternative domestic cold water circuit inlet or connection for more boilers
4	Lower heat exchanger outlet
5	Heat exchanger flange Lower
6	Lower heat exchanger inlet
7-12	Connection for instrumentation 1/2" Gas F
8	Connection for magnesium anode 1 1/4" Gas F
9	Upper heat exchanger outlet
10	Heat exchanger flange Upper
11	Upper heat exchanger inlet
13	Connection for 2 nd anode 1 1/4" Gas F (only for models > 1500)
14	Connection for electrical immersion 1 1/2" Gas F For models > 800 connection 2" Gas F
15-17	Connection for recirculation or for domestic hot water
16	Connection for instrumentation 1/2" Gas F
18	Domestic hot water outlet
19-20	Heat exchangers air purge 3/8" Gas F

Model	Volume [lt]	Df (vers. XXC) [mm]	De (vers. XXC) [mm]	De (vers. XXB) [mm]	H	A	H1	H2	H3	H4	H5	H6	H7	H8	H9
200	195	//	//	550	1451	1552	81	316	351	401	451	511	701	801	851
300	297	//	//	650	1569	1698	149	409	444	494	544	604	794	894	944
500	507	//	//	750	1861	2006	141	426	461	511	561	621	811	911	961
800	768	790	1010	//	1943	2008	113	428	473	563	653	713	863	1003	1093
1000	910	800	1020	//	2212	2270	112	437	482	572	662	722	922	1032	1122
1300	1283	950	1210	//	2193	2275	118	433	578	668	758	818	918	1078	1168
1500	1409	1000	1260	//	2177	2266	112	447	592	682	772	832	982	1142	1232
2000	2032	1250	1510	//	2099	2231	134	529	649	754	859	929	1004	1229	1334
2500	2320	1250	1350	//	2299	2396	134	529	649	754	859	929	954	1249	1354
3000	2925	1250	1350	//	2799	2879	134	529	709	814	919	989	1014	1349	1454
4000	3776	1400	1500	//	2872	2968	117	557	737	842	947	1017	1022	1377	1482
5000	4995	1600	1700	//	2909	3031	94	564	734	839	944	1014	1019	1384	1489

Model	H10	H11	H15	H16	H17	5 10	1	2-3 15-17	4-6 9-11	7 12-16	8	13	14	19-20	18
200	901	961	//	1066	1176	Øe 300	3/4"	1 1/4"	1"	1/2"	1 1/4"	//	1 1/2"	3/8"	1 1/4"
300	994	1054	//	1159	1269	Øe 300	3/4"	1 1/4"	1"	1/2"	1 1/4"	//	1 1/2"	3/8"	1 1/4"
500	1011	1071	//	1380	1536	Øe 300	3/4"	1 1/4"	1"	1/2"	1 1/4"	//	1 1/2"	3/8"	1 1/4"
800	1183	1243	//	1382	1538	Øe 380	3/4"	1 1/4"	2"	1/2"	1 1/4"	//	1 1/2"	3/8"	1 1/2"
1000	1212	1272	//	1642	1797	Øe 380	3/4"	1 1/2"	2"	1/2"	1 1/4"	//	2"	3/8"	1 1/2"
1300	1258	1318	//	1638	1793	Øe 380	1"	1 1/2"	2"	1/2"	1 1/4"	//	2"	3/8"	2"
1500	1322	1382	//	1602	1757	Øe 380	1"	1 1/2"	2"	1/2"	1 1/4"	1 1/4"	2"	3/8"	2"
2000	1439	1404	1524	1473	1629	Øe 430	1"	2"	2"	1/2"	1 1/4"	1 1/4"	2"	3/8"	2"
2500	1459	1529	1794	1710	1879	Øe 430	1"	2"	2"	1/2"	1 1/4"	1 1/4"	2"	3/8"	2"
3000	1559	1629	2294	2210	2369	Øe 430	1"	2"	2"	1/2"	1 1/4"	1 1/4"	2"	3/8"	2"
4000	1587	1657	2302	2225	2397	Øe 430	1"	2"	2"	1/2"	1 1/4"	1 1/4"	2"	3/8"	2"
5000	1594	1664	2319	2159	2404	Øe 430	1"	2"	2"	1/2"	1 1/4"	1 1/4"	2"	3/8"	2"