

# EXTRA1 HORIZONTAL

POLYWARM® COATED CALORIFIERS WITH 1 STAINLESS STEEL EXTRACTABLE HEAT EXCHANGER



## APPLICATION

Production and storage of domestic hot water.

## MATERIAL

Mild steel Polywarm® coated (Attestation ACS - SSICA - DVGW - W270 - UBA - WRAS)

## HEAT EXCHANGER

1 heat exchanger with 316L stainless steel or copper tubes.

## INSULATION (DISMOUNTABLE)

NOFIRE® polyester fleece 100% made of recyclable material, with high thermal insulation. Fire resistance class B-s2d0 according to EN 13501. Grey PVC external lining.

## CATHODE PROTECTION

Magnesium anode. Models > 1500 n° 2 magnesium anode.

## GASKET- FLANGE PLATE

Silicone gaskets suitable for alimentary use for max temperature up to 200°C. Mild steel exchanger head with anticorrosion treatment.

## WARRANTY

5 years - See general sales conditions and warranty

## ACCESSORIES AND SPARE PARTS

See Accessories section for the entire list.



SOFT FLEECE INSULATION

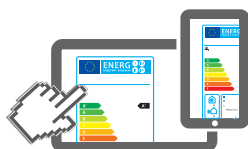

[www.cordivari.com/erp](http://www.cordivari.com/erp)

On line ErP label tool

## EXTRA 1 WXC OR

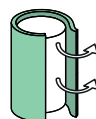

### DISMOUNTABLE SOFT FLEECE insulation

STAINLESS STEEL  
HEAT EXCHANGER  
SURFACE

ENERGY  
EFFICIENCY  
CLASS

ErP

Model	Art. Nr.	[m <sup>2</sup> ]	
<b>200</b>	3072161430031	0,5	<b>C</b>
<b>300</b>	3072161430032	0,75	<b>C</b>
<b>500</b>	3072161430033	1	<b>C</b>
<b>800</b>	3072161430034	1,5	<b>C</b>
<b>1000</b>	3072161430035	2	<b>C</b>
<b>1500</b>	3072161430036	3	<b>C</b>
<b>2000</b>	3072161430037	4	<b>C</b>
<b>3000</b>	3072161430008	5	
<b>4000</b>	3072161430009	8	
<b>5000</b>	3072161430011	10	

Data have been calculated on following basis: Primary circuit at 80 °C, and proper energy source; Production of DHW in continue way from 10 °C at t2; DHW that can be taken in the first 10' and in the first hour from storage at 60°C, input 10°C and output 45°C; Sanitary water according to UNI CTI 8065. Even if tanks are tested to resist till max temperature, the local legislation has always to be observed during the use.

Model	Ignition Time	Output	Continuous production of DHW	DHW produced in the first 10 Min.	DHW produced in the first hour	Flow rate	Exchanger pressure loss
	[min]	[Kw]	[lt/h]	[lt/10']	[lt/60']	[m <sup>3</sup> /h]	[mm.H <sub>2</sub> O]
<b>200</b>	49	18	455	347	635	2	30,3
<b>300</b>	48	28	701	524	968	3	36,5
<b>500</b>	60	38	947	844	1443	4	41,1
<b>800</b>	59	59	1466	1301	2230	6	70,4
<b>1000</b>	54	86	2127	1776	3123	10	135,3
<b>1500</b>	53	133	3290	2677	4761	15	225,1
<b>2000</b>	52	180	4453	3564	6384	20	293,8
<b>3000</b>	65	216	5361	5144	8539	20	238,9
<b>4000</b>	57	330	8168	6918	12092	20	382,1
<b>5000</b>	60	401	9921	8639	14923	20	461,6

## Accessories on request

### "Easy Control" Electronic Display

ART. NR.	FOR MODELS
5005000310002	WXC



### Thermometer

Art. Nr.
5032240000107
5 units box



### Titanium electronic anode

Art. Nr.	Model
5200000000008	200, 300
5200000000009	500, 800
5200000000011	1000, 1500
5200000000013	2000÷5000



# EXTRA1 HORIZONTAL

POLYWARM® COATED CALORIFIERS WITH 1 STAINLESS STEEL EXTRACTABLE HEAT EXCHANGER

STORAGE		HEAT EXCHANGER	
Pmax	Tmax	Pmax	Tmax
8 bar	90 °C	12 bar	110 °C



**CORDIVARI Lab**  
TÜV Rheinland Energie und Umwelt GmbH states that test procedures and Cordivari LAB are certified conforming to European standard EN 15332, as indicated by Ecodesign ErP Directive.



ASK ALWAYS FOR  
CERTIFIED LABORATORIES  
DATA RESULTS

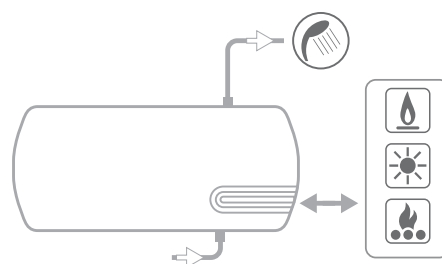
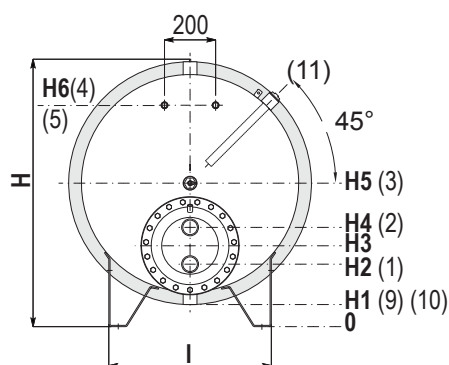
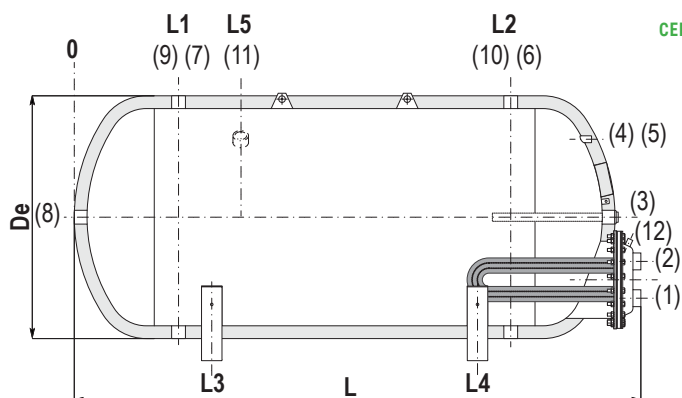

1	Primary circuit outlet
2	Primary circuit inlet
3	Connection for magnesium anode
4 - 5	Connection for instrumentation 1/2" Gas F
6 - 7	Domestic hot water outlet
8	Recirculation
9 - 10	Domestic hot water inlet / Drain
11	Connection for 2 <sup>nd</sup> anode 1"1/4 Gas F (only for models > 1500)
12	Heat exchanger air purge 3/8" Gas F

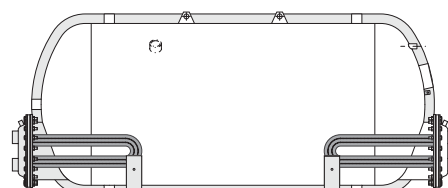

VERSION WITH 2 EXTRACTABLE HEAT EXCHANGERS ARE AVAILABLE UPON REQUEST

Model	Volume [lt]	De	L	H	L1	L2	L3	L4	L5	H1
		[mm]								
<b>200</b>	191	670	1594	693	344	1144	409	1079	//	43
<b>300</b>	292	770	1645	849	370	1170	440	1100	//	99
<b>500</b>	500	870	1934	946	395	1445	490	1350	//	96
<b>800</b>	795	970	2251	1042	425	1725	555	1595	//	92
<b>1000</b>	1045	1070	2281	1137	458	1758	588	1628	//	87
<b>1500</b>	1498	1210	2651	1240	474	2024	629	1869	//	90
<b>2000</b>	2064	1360	2706	1380	520	2070	660	1930	908	80
<b>3000</b>	2997	1350	2956	1524	495	2295	695	2095	945	154
<b>4000</b>	4184	1550	3066	1707	560	2360	665	2255	1010	137
<b>5000</b>	5131	1700	3107	1845	583	2383	783	2183	1033	125

Model	H2	H3	H4	H5	H6	I	1-2	4-5	3-8	6-7-9-10	11
	[mm]						Connections Gas F				
<b>200</b>	243	293	343	368	498	364	1"	1/2"	1"1/4	1"1/4	-
<b>300</b>	336	386	436	474	668	404	1"	1/2"	1"1/4	1"1/4	-
<b>500</b>	383	433	483	521	715	455	1"	1/2"	1"1/4	1"1/4	-
<b>800</b>	348	438	528	567	817	583	2"	1/2"	1"1/4	1"1/2	-
<b>1000</b>	277	367	457	612	917	644	2"	1/2"	1"1/2	1"1/2	-
<b>1500</b>	315	405	495	665	1020	759	2"	1/2"	2"	2"	-
<b>2000</b>	330	435	540	730	1085	848	2"	1/2"	2"	2"	1"1/4
<b>3000</b>	324	429	534	829	1184	981	2"	1/2"	2"	2"	1"1/4
<b>4000</b>	307	412	517	912	1267	1101	2"	1/2"	2"	3"	1"1/4
<b>5000</b>	305	410	515	975	1330	1189	2"	1/2"	2"	3"	1"1/4