



APPLICATION

Production and storage of domestic hot water.

MATERIAL

Mild steel Polywarm® coated (Attestation ACS - SSICA - DVGW - W270 - UBA - WRAS).

HEAT EXCHANGER

Double walled heat exchanger.

INSULATION

High thermal insulation with ecological polyurethane hard foam.

Grey PVC external lining

CATHODE PROTECTION

Magnesium anode.

WARRANTY

5 years - See general sales conditions and warranty

ACCESSORIES AND SPARE PARTS : See Accessories section for the entire list.



HARD FOAM INSULATION

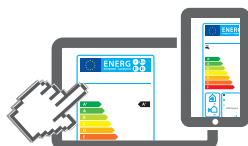

www.cordivari.com/erp

On line ErP label tool

INTERKA WB

HEAT EXCHANGER SURFACE ENERGY EFFICIENCY CLASS

Model	HARD FOAM insulation Art. Nr.	[m ²]	ErP
80	3203160310001	0,36	C
100	3203160310002	0,54	C
150	3203160310003	0,82	C
200	3203160310004	1,00	C
300	3203160310015	1,40	C

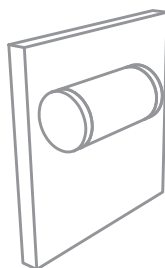
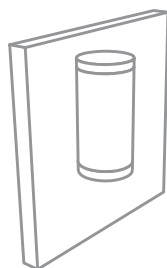

Vertical or horizontal wall hanged

Model	Output	Ignition time	Production of D.H.W.		Weight
	[kW]	[min]	[lt/h]	[lt/10']	
80	8	27	190	112	24
100	11	24	263	144	30
150	15	26	372	212	41
200	20	25	508	285	49
300	24	31	606	401	65

Data have been calculated on following basis:

- primary water at 80°C
- DHW production from 10°C to 45°C.

Even if tanks are tested to resist from max temp. 60 °C to 90 °C the local legislation has always to be observed during the use.

Accessories on request

Electric immersion with thermostat

Art. Nr.	Output	Con- nection	
5240000000042	1,5 kW	1" 1/4	

Thermometer

Art. Nr.
5032240000107
5 units box



Magnesium anode

ART. NR.	Model
5200000041015	80÷150
5200000041010	200÷300
2 units box	



STORAGE		HEAT EXCHANGER	
Pmax	Tmax	Pmax	Tmax
6 bar	90 °C	1,5 bar	99 °C

CORDIVARI Lab
TÜV Rheinland Energie und Umwelt GmbH states that test procedures and Cordivari LAB are certified conforming to European standard EN 15332, as indicated by Ecodesign ErP Directive.

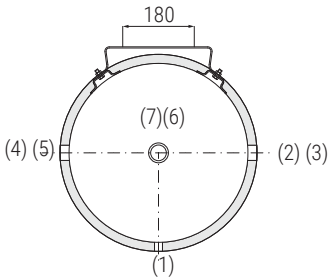
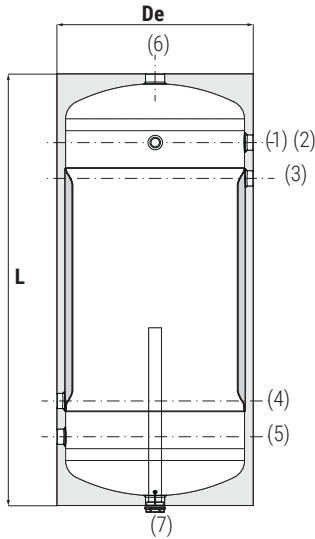
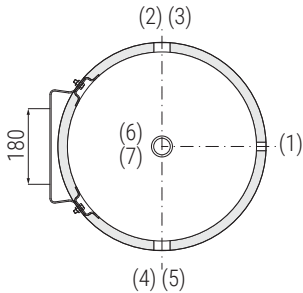
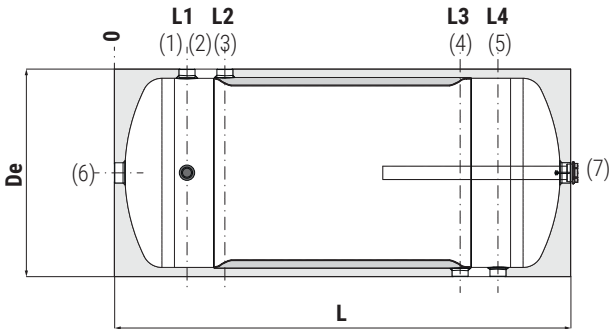
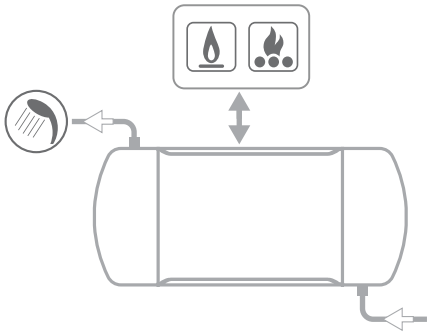

- 1 Instrumentation 1/2" Gas F
- 2 Domestic hot water outlet
- 3 Entry heating water from the buffer
- 4 Heating water back to the buffer
- 5 Domestic cold water circuit inlet
- 6 Recirculation/electrical immersion resistance 1 1/4 Gas F
- 7 Connection for magnesium anode 1 1/4 Gas F

POSSIBLE VERTICAL INSTALLATION

NOTE:
THIS INSTALLATION MAY REDUCE THE D.H.W. STORAGE VOLUME.

Model	Volume [lt]	De	L	L1	L2	L3	L4	2-3-4-5 Connections Gas F
80	82	456	770	165	260	510	605	1"
100	100	456	920	165	260	660	755	1"
150	152	510	1086	173	268	818	913	1"
200	203	560	1170	190	285	885	980	1"
300	293	610	1399	230	325	1075	1170	1"