

# AUTOCLAVE INOX X PED VT

CERTIFIED VERTICAL 316L STAINLESS STEEL PRESSURE VESSEL (DIRECTIVE 2014/68/UE)



PRESSURE	TEMPERATURE
Pmax	Tmax
8 bar	-10 / +50 °C

HORIZONTAL VERSION



AUTOCL. X PED VT	
Model	Art. Nr.
<b>100</b>	3051052010001
<b>200</b>	3051052010002
<b>300</b>	3051052010003
<b>500</b>	3051052010004
<b>750</b>	3051052010005
<b>1000</b>	3051052010006
<b>1500</b>	3051052010007
<b>2000</b>	3051052010008
<b>3000</b>	3051052010009
<b>4000</b>	3051052010010
<b>5000</b>	3051052010011

AUTOCL. X PED OR	
Model	Art. Nr.
<b>100</b>	3051051010001
<b>200</b>	3051051010002
<b>300</b>	3051051010003
<b>500</b>	3051051010004
<b>750</b>	3051051010005
<b>1000</b>	3051051010006
<b>1500</b>	3051051010007
<b>2000</b>	3051051010008
<b>3000</b>	3051051010009
<b>4000</b>	3051051010010
<b>5000</b>	3051051010011

## APPLICATION AND TECHNICAL DESCRIPTION

Air cushion pressure vessels.

Suitable to supply water to the highest floor of the buildings and to compensate for the water shortage of the water-works.

The air cushion pressure vessels X PED VT are made for the water pumping and they work as a pressured water lung that, if correctly dimensioned, can limit the self-starting of the pump. These products are entirely made in 316L stainless steel.

### DOCUMENTS ATTACHED

- CE certification
- User Instructions

## CERTIFICATIONS

The X PED VT pressure vessels are made according to the security policy of the standard 2014/68/UE that rules the pressurized products. Under surveillance of the Notified Body, a CE mark is stuck on them as well as the following project data that characterize the product:

- Pressurized fluid: water + air or nitrogen
- Fluid group: 2
- Max operating pressure: see the table chart
- Temperature: -10/+50 °C

### WARRANTY

2 years

See general sales conditions and warranty.

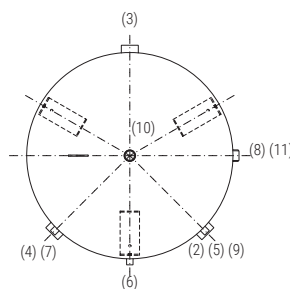
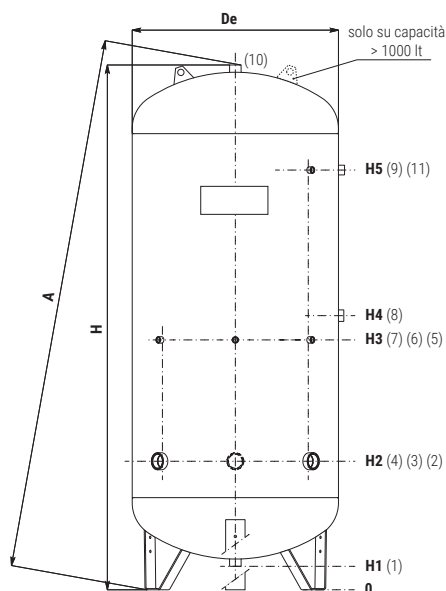

<b>1</b>	Drain
<b>2-3-4</b>	Input - use
<b>5</b>	Visual level indicator
<b>6-7</b>	Control elements
<b>8</b>	Level switch - Pressure switch
<b>9</b>	Visual level indicator
<b>10</b>	Safety Valve
<b>11</b>	Level switch - Pressure switch



Manometer

Safety Valve

As standard for pressure vessels from 100 to 1000 lt (8 bar)

Model	De	H	A	H1	H2	H3	H4	H5	1-8-10	2-3-4	5-6-7-9	11
[mm]												
<b>100</b>	400	1071	1095	97	372	522	622	797	1" 1/4	1"	1/2"	-
<b>200</b>	450	1459	1490	70	365	665	765	1165	1" 1/4	1"	1/2"	-
<b>300</b>	550	1554	1585	135	445	745	845	1245	1" 1/4	1" 1/4	1/2"	-
<b>500</b>	650	1847	1880	127	462	862	962	1512	1" 1/4	1" 1/2	1/2"	1"
<b>750</b>	750	2133	2170	103	518	968	1068	1718	1" 1/4	2"	1/2"	1"
<b>1000</b>	850	2633	2665	103	518	1168	1268	2218	1" 1/4	2"	1/2"	1"
<b>1500</b>	1000	2295	2350	105	600	1100	1200	1800	1" 1/4	2"	1/2"	1"
<b>2000</b>	1000	2795	2840	105	600	1250	1350	2300	1" 1/4	2"	1/2"	1"
<b>3000</b>	1250	2880	2955	110	645	1245	1345	2345	1" 1/4	3"	1/2"	1"
<b>4000</b>	1450	2973	3070	84	679	1279	1379	2379	1" 1/4	3"	1/2"	1"
<b>5000</b>	1450	3473	3555	84	679	1579	1679	2879	1" 1/4	3"	1/2"	1"