

VOLANO TERMICO CALDO-FREDDO R/C GB VT

VERTICAL INERTIAL HOT/COLD WATER TANK BOX

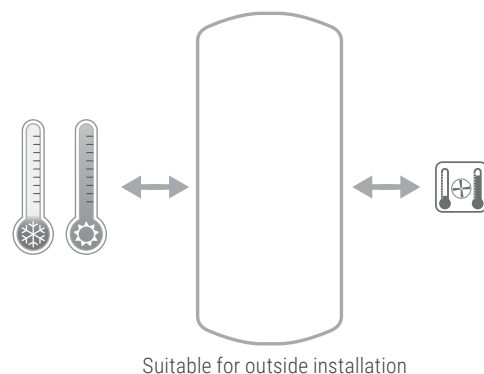

PRESSURE	TEMPERATURE
Pmax	Tmax
6 bar	-10 / +90 °C



APPLICATION AND TECHNICAL DESCRIPTION

Storage of chilled or hot water for inverter installations.

These buffers are with hard box insulation and an external lining with a galvanized and painted plate, raw inside. They are suited for installation that works with cold water during Summer and hot water during Winter.

They also allow to limit the number of switch on/off of the generator (either heat pump, chilled system or standard Generator) increasing the thermic inertia of the system and to have more stable temperatures

MATERIAL

Mild steel

EXTERNAL LINING

Galvanized and painted metallic cover.

INSULATION

High thermal insulation with ecological polyurethane hard foam.

WARRANTY

2 years

See general sales conditions and warranty.

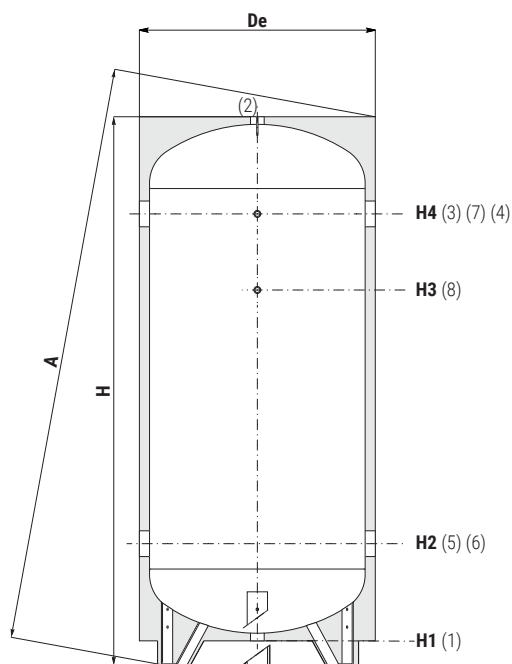

VOLANO TERMICO CALDO-FREDDO

ENERGY EFFICIENCY CLASS

Model _____

Art. Nr.

Model	Art. Nr.	ENERGY EFFICIENCY CLASS
100	3001162310501	C
200	3001162310502	C
300	3001162310503	C
500	3001162310524	C
800	3001162310525	C
1000	3001162310526	C
1500	3001162310527	C
2000	3001162310528	C



1	Drain
2	Safety Valve
3-4-5-6	To the System
7-8	Connection for Instrumentation 1/2" Gas F

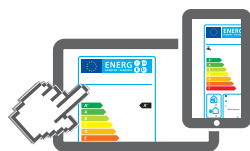

www.cordivari.com/erp

On line ErP label tool



CORDIVARI Lab

TÜV Rheinland Energie und Umwelt GmbH states that test procedures and cordivari LAB are certified conforming to European standard EN 15332, as indicated by Ecodesign ErP Directive.



ASK ALWAYS FOR CERTIFIED LABORATORIES DATA RESULTS

Model	Weight [Kg]	Volume [litres]	De	H	A	H1	H2	H3	H4	1 2	5 - 6 - 3 - 4	7 - 8
										Connections Gas F		
100	32	101	//	1006	1017	73	287	592	792	1"1/4	1"1/2	1/2"
200	53	190	//	1407	1415	68	297	927	1177	1"1/4	1"1/2	1/2"
300	67	292	//	1518	1529	129	404	994	1244	1"1/4	2"	1/2"
500	101	501	750	1790	1941	80	400	1200	1450	1"1/4	3"	1/2"
800	147	788	900	2100	2285	80	430	1437	1730	1"1/4	3"	1/2"
1000	170	1034	1000	2166	2386	80	463	1463	1763	1"1/2	3"	1/2"
1500	183	1432	1100	2366	2609	100	471	1681	1981	2"	3"	1/2"
2000	219	1970	1300	2436	2761	100	506	1716	2016	2"	3"	1/2"