



ELEN 18

SATIN STAINLESS STEEL

MATERIAL:

- Vertical collectors in satin stainless steel \varnothing 30 mm.
- Horizontal elements in satin stainless steel \varnothing 18 mm.

FIXING KIT:

Brackets, airvent, hexagonal tool, plugs and screws for mounting suitable for use on compact or hollow brick, user notice.
The kit is certified from TÜV in compliance with VDI 6036-class 4.

PACKAGING:

Carton angular and profiles protected by a recyclable film in polyethylene. User notice included.

FEATURES:

It is totally made in stainless steel with an unalterable finishing guaranteed during the years.

ACCESSORIES:

See Accessories chapter

Functioning:	<input checked="" type="checkbox"/> Hot water		<input checked="" type="checkbox"/> Dual energy
--------------	---	--	---

P. Max: 8 bar	Functioning: hot water	T. Max: 110° C	Connections: 2 x 1/2" gas - 1 x 1/2" gas for airvent
---------------	------------------------	----------------	--

CERTIFICATIONS



ACCESSORIES



Kristal valve square with thermostatic option-satin

Copper conn. \varnothing 12/14/15
Art. nr. 5991990321143

Multilayer conn. \varnothing 16
Art. nr. 5991990321144

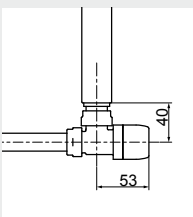

Quotes for square Kristal valves with thermostatic option



Kit 2 hooks-satin stainless steel

Art. nr. 5991990010217



Towel bar-satin stainless steel (width 350 mm)

Art. nr. 5991990010222

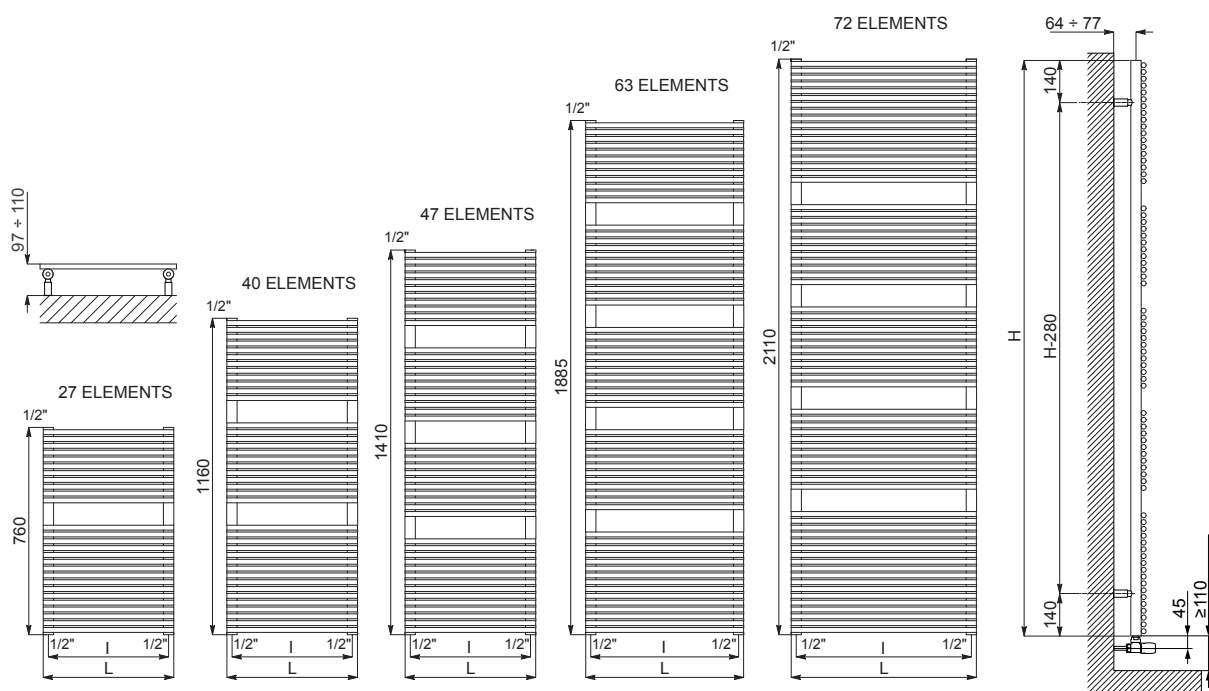
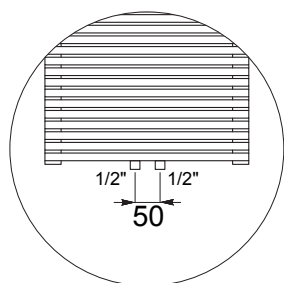

Quotes for Kristal valves

ELEN 18 SATIN STAINLESS STEEL				Pipe Centres 50 mm		Thermal output [Watt]						Dual energy kit
Height [mm]	WIDTH L [mm]	Pipe Centres l [mm]	Art. nr.	Art. nr.	Dry Weight [Kg]	Surface [m2]	Water con- tent [lt]	Δt=50°C	Δt=30°C	Exp. n	[Watt]	
760	430	400	3551590133040	3551590133057	7,8	0,8	3,5	291	151	1,2856	300	
	480	450	3551590133044	3551590133061	9,2	0,9	4,0	370	193	1,2714	400	
1160	430	400	3551590133041	3551590133058	11,5	1,2	5,3	434	226	1,2795	500	
	480	450	3551590133045	3551590133062	13,7	1,4	6,0	545	286	1,2634	600	
	530	500	3551590133048	3551590133065	15,7	1,6	6,8	657	346	1,2527	700	
	580	550	3551590133052	3551590133069	19,8	2,1	8,3	880	467	1,2395	900	
1410	430	400	3551590133042	3551590133059	13,7	1,4	6,3	509	265	1,2762	600	
	480	450	3551590133046	3551590133063	16,2	1,7	7,2	636	334	1,2590	700	
	530	500	3551590133049	3551590133066	18,6	1,9	8,1	764	404	1,2476	900	
	580	550	3551590133053	3551590133070	23,3	2,4	9,9	1020	543	1,2334	1200	
1885	430	400	3551590133043	3551590133060	18,3	1,9	8,4	701	375	1,2236	700	
	480	450	3551590133047	3551590133064	21,7	2,2	9,6	868	455	1,2631	900	
	530	500	3551590133050	3551590133067	24,9	2,6	10,8	1014	532	1,2630	900	
	580	550	3551590133054	3551590133071	31,2	3,3	13,2	1317	706	1,2192	1200	
2110	530	500	3551590133051	3551590133068	24,6	2,5	10,9	945	501	1,2436	900	
	580	550	3551590133055	3551590133072	28,3	2,9	12,3	1120	598	1,2293	1200	
	730	700	3551590133056	3551590133073	35,6	3,8	15,0	1472	793	1,2113	1200	

For output at different Δt than 50°C, please refer to the following formula: desired output = output at Δt 50°C x (desired Δt/50)ⁿ