

# LEILA

## POLISHED STAINLESS STEEL



**WARRANTY**  
**10 YEARS**

### MATERIAL:

- Vertical collectors in polished stainless steel  $\varnothing$  30 mm.
- Horizontal elements in polished stainless steel  $\varnothing$  18 mm.

### FIXING KIT:

Brackets, airvent, hexagonal tool, plugs and screws for mounting suitable for use on compact or hollow brick, user notice.  
The kit is certified from TÜV in compliance with VDI 6036-class 4.

### PACKAGING:

Carton angular and profiles protected by a recyclable film in polyethylene. User notice included.

### FEATURES:

It is totally made in stainless steel with an unalterable finishing guaranteed during the years.

### ACCESSORIES:

See Accessories chapter

Functioning:	<input checked="" type="checkbox"/> Hot water	<input checked="" type="checkbox"/> Electric (see page 352)	<input checked="" type="checkbox"/> Dual energy
--------------	---	---	---

P. Max: 8 bar	Functioning: hot water	T. Max: 110° C	Connections: 2 x 1/2" gas - 1 x 1/2" gas for airvent
---------------	------------------------	----------------	--

## CERTIFICATIONS



## ACCESSORIES



**Kristal valve square with thermostatic option-chromed**

Copper conn.  $\varnothing$  12/14/15  
Art. nr. 5991990311165

Multilayer conn.  $\varnothing$  16  
Art. nr. 5991990311166

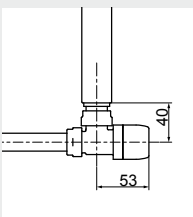

Quotes for square Kristal valves with thermostatic option



**Kristal corner valve with thermostatic option-chromed**

Copper conn.  $\varnothing$  12/14/15  
Art. nr. 5991990301148

Multilayer conn.  $\varnothing$  16  
Art. nr. 5991990301147

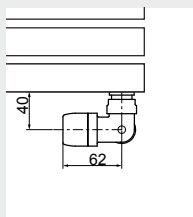

Quotes for corner Kristal valves with thermostatic option



**Chromed thermostatic head**

(Kit 2 pieces)  
Art. nr. 5035270710015

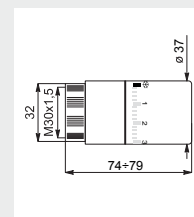

Thermostatic head quotes

Accessories and spare parts - see Accessories chapter

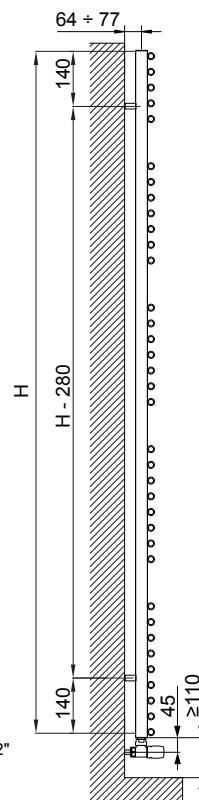
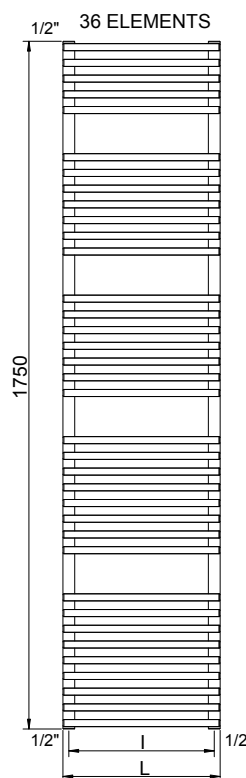
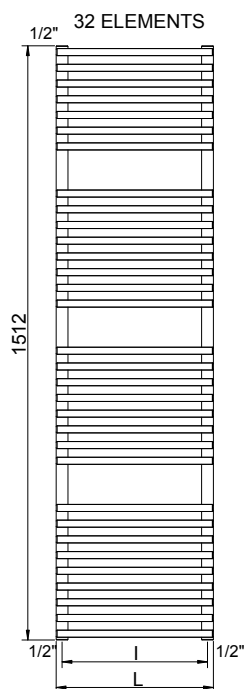
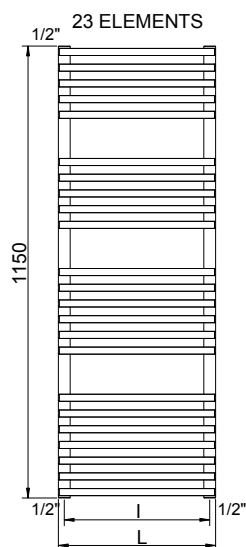
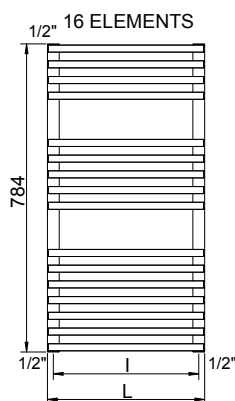
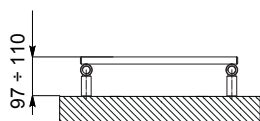
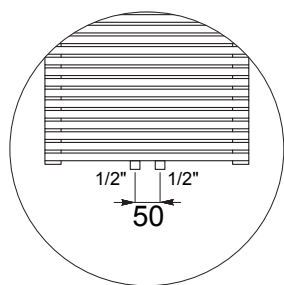

Quotes for Kristal valves

## LEILA POLISHED STAINLESS STEEL

LEILA POLISHED STAINLESS STEEL				Pipe Centres 50 mm		Thermal output [Watt]						Dual energy kit
Height [mm]	WIDTH L [mm]	Pipe Centres I [mm]	Art. nr.	Art. nr.	Dry Weight [Kg]	Surface [m2]	Water con- tent [lt]	Δt=50°C	Δt=30°C	Exp. n	[Watt]	
784	400	370	3551560400001	3551560400051	5,7	0,50	2,0	217	118	1,2007	300	
	450	420	3551560400002	3551560400052	6,2	0,55	2,2	237	129	1,1963	300	
	500	470	3551560400003	3551560400053	6,6	0,60	2,3	258	140	1,1919	300	
	600	570	3551560400005	3551560400055	7,6	0,69	2,6	299	163	1,1831	400	
1150	400	370	3551560400006	3551560400056	8,2	0,73	3,0	313	167	1,2306	400	
	450	420	3551560400007	3551560400057	8,9	0,82	3,1	342	182	1,2324	400	
	500	470	3551560400008	3551560400058	9,6	0,87	3,3	370	197	1,2342	500	
	600	570	3551560400010	3551560400060	11,0	0,99	3,7	428	227	1,2378	500	
1512	800	770	3551560400021	3551560400071	13,3	1,27	4,5	544	288	1,2426	700	
	400	370	3551560400011	3551560400061	11,2	1,00	4,0	416	220	1,2434	500	
	450	420	3551560400012	3551560400062	12,1	1,10	4,3	455	242	1,2393	600	
	500	470	3551560400013	3551560400063	13,1	1,19	4,6	493	262	1,2352	600	
1750	600	570	3551560400015	3551560400065	15,1	1,37	5,1	570	305	1,2270	700	
	800	770	3551560400022	3551560400072	18,3	1,73	6,2	724	389	1,2159	900	
	400	370	3551560400016	3551560400066	12,7	1,14	4,6	490	259	1,2518	600	
	450	420	3551560400017	3551560400067	13,8	1,25	4,9	536	284	1,2438	700	
1750	500	470	3551560400018	3551560400068	14,9	1,34	5,2	581	307	1,2459	700	
	600	570	3551560400020	3551560400070	17,1	1,55	5,9	673	361	1,2199	900	
	800	770	3551560400023	3551560400073	20,7	1,95	7,1	857	468	1,1852	1200	

For output at different  $\Delta t$  than  $50^{\circ}\text{C}$ , please refer to the following formula: desired output = output at  $\Delta t 50^{\circ}\text{C} \times (\text{desired } \Delta t/50)^{1,4}$